

## The Hazel Dell Township School #2

© 2016 by Robert A. "Bob" Christiansen, updated 1 May '16.

The one-room rural Hazel Dell #2 school, generally called the *Parish School*, served the north central portion of Hazel Dell Township in Pottawattamie County, Iowa, north of Council Bluffs. It was located about five miles west and one mile north of Underwood. The Hazel Dell #2 subdistrict occupied Sections 3, 4, 9 and 10 of Hazel Dell Township and consisted of hilly, partially wooded land on the backside of the loess hills.

In the map on page 3, the Parish School is the black square in Section 10 just southwest of the four corners. Parish Grove, the site of many memorable picnics in the past, was across the road and to the west of Parish School.

Contents	page
Known Hazel Dell #2 Teachers	2
Selected Hazel Dell #2 Families	2
1919 Hazel Dell #3 School Subdistrict Map	3
Some Notes on the Parish School Families	4
c. 1925 Parish School Photo With Identifications	6
1926 Parish School PTA Photo With Identifications (3 parts)	7
The 1926 Parish School PTA Photo Family Sketches	10

For general information about Hazel Dell Township schools, including a diagram of school locations in Hazel Dell Township, see my report *Boomer and Hazel Schools*.

For an 1875 map and a current map of Hazel Dell Township, see my report *Boomer and Hazel Dell Townships Overview*.

I would appreciate hearing from you if you have further photos with identifications. My contact information is in the *Acknowledgments and Sources* section of *Boomer and Hazel Dell Schools*.

## **Known Hazel Dell #2 Teachers**

c. 1925-26	Nellie Voss, d/o Fred & Margaret Voss of Beebeetown, m. Howard Smith, m. David Mackland.
1935-1942	Pearl Darrington, d/o William & Christina Darrington, m. Hans Pedersen.
1942-43	School is closed due to low enrolment or lack of teachers? (ask Cleo)
1956-57	Mrs. Hazel Coffman

## **Selected Hazel Dell #2 Families**

This report includes the families shown in two photographs taken in the mid 1920s:

- Parish School students and teacher in a c. 1925 snapshot found in the belongings of Florence (Larson) Larsen.
- Members of the Parish school PTA including most Parish School children in a professional photo dated May 21, 1926.

**Pictured on one or both of these photographs are the following:**

- Christensen, Chris K. & Lydia
- Lydia's brother, Walter Jacobsen, a bachelor
- Hough, Ernest  
the Hough housekeeper, Esther Finn (later Mrs. Joel Raymond Wright), and her son, Maurice Finn
- Hukill, Mary, and son, Walter
- Jensen, Christine (widow of Chris), and children, Milton, Erwin & Arlene
- Jensen, Henry & Tina, and children, LaRue & Maynard
- Larson, Henry & Ellen, and daughter, Evelyn
- Ellen's brother, Hans Peter "Pete" Hansen, a bachelor
- Olsen, James & Sadie, children, Mildred & Richard, Sadie's mother, Daisy Willmott, Jim's niece, Mildred Beedle, and Sadie's cousin, Edna McKeown
- Parish, Rozel & Mary, and children, Lorene, Blanche, Marvin, Ralph & Bernice
- Parish, Elmer (Rozel's cousin) & Tillie, and children, Etta, Dorothy & Pearl
- Handlen, Frank & Sarah (Rozel's sister), and two of their three sons, Leslie, Vere & Lynn (we're not sure of the identifications of the Handlen sons)
- Christensen, Irene (daughter of Alfred B. Christensen and Etta Ann Parish – Etta is Elmer's sister)
- Voss, Nellie, the teacher, later Nellie (Voss) Smith Mackland
- Wright, Marl, Dorothy & Orville (children of Adolph Benjamin Wright and Martha Cathrine Jorgensen)

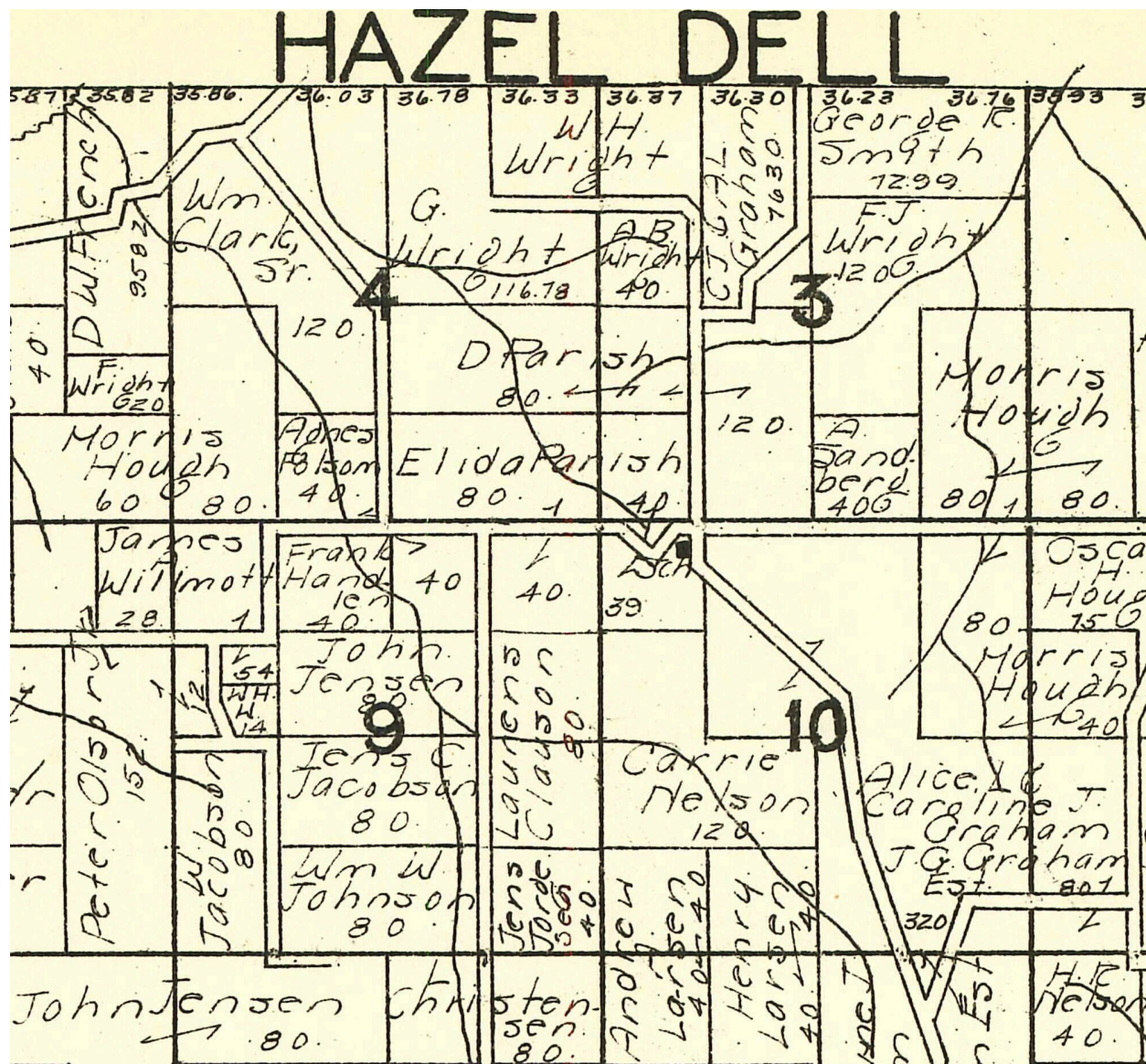

### **The Parish School (Hazel Dell #2) Subdistrict in 1919**

Above map taken from the 1930 Hixson Plat Book of Pottawattamie County, Iowa, which one can view on-line at [digital.lib.uiowa.edu](http://digital.lib.uiowa.edu). Although the book is dated 1930, it appears to use a 1919 plat. Search for Hixson Pottawattamie.

## Some Notes on the Parish School Families

Looking at the 1919/1930 map on the previous page, you'll see holdings for three early families still living in the district in 1926, Wright, Parish and Hough.

- Of the Parish School district residents in 1926, only the Wright family had bought land from the United States government. The Wrights settled in north central Hazel Dell Township in the spring of 1860.
- Two brothers, Delorma and Elida Parish, settled in north central Hazel Dell Township around the late 1860s. Delorma married Eletha Jane Hall in 1862, lived in Utah from 1863 to 1867, and was the father of Sarah Adelia (Parish) Handlen and Rozel Parish. Elida married Jane Tucker Nelson in 1866 and was the father of Elmer Parish.
- Members of the Hough extended family came to the Council Bluffs area with the first Mormons in 1846. Some in the Hough family settled in the Crescent area. Morris Hough (1843 – 1930) opened a farm in Hazel Dell Township, Section 3 around 1869 and died on this farm over sixty years later.

Two wealthy families were absentee landlords in the Parish School district:

- The Grahams, with holdings in Section 10 and elsewhere in Hazel Dell Township, were absentee landlords from Canton, Illinois, and acquired thousands of land from the United States government in the 1850s. In 1926 the Hukill family and my great-uncle, Hans Peter Hansen, were tenants on Graham land, as were my grandparents, Andrew and Maggie Larson, who lived just to the south in the Center School subdistrict.
- Members of the Folsom family had come to Council Bluffs in the early 1850s. In the 1885 plat, they owned about a section of land in north central Hazel Dell Township. Jeremiah Folsom's widow, Agnes, continued to own an 80-acre farm in Sections 4 and 9 until around 1940. This was the farm on which the widow Christine Jensen lived. (Incidentally, Agnes Folsom's house at 135 S. 3<sup>rd</sup> St. in Council Bluffs, built around 1853, is still standing.)

In her memoir "PTA and Country School (Hazel Dell #2)", Cleo (Peterson) Christoffersen recalled that she started Hazel Dell #2 in 1935. For the eight years she attended (there was no kindergarten), Pearl Darrington was her only teacher. She recalled the following fellow-students, whom I have put into families here:

- Paul and Pauline **Banther** (foster parents Chris K. Christensen and Lydia Jacobsen).
- Olga, Ralph, Irene, Elva and Leona **Clausen** (parents Harold Clausen & Carrie Petersen).
- Wanda and Wilma **Handlen** (parents Leslie Handlen & Edna Jensen).
- Viola **Jensen** (parents Carl Jensen & Annie Johnson).
- Robert **Jensen**. This may be the son of Albert Jensen & Eva Jensen. However, his siblings, Marjorie, Shirley and Sarah, should be listed.
- Ardythe **Olsen** (parents Albert Olsen & Sally Boren).



- Robert **Olsen**. This may be Ardythe's cousin, son of Howard Jensen & Geraldine Johnson.
- Manley, Irvin and Gilbert **Orr** (parents Andrew Orr & Minnie Ahrens).
- Calvin, Orvan, Orpha and Cleo **Peterson** (parents Henry T. Peterson & Edna Nelson).



**c. 1925 Parish School Students and Teacher**

First row: Pearl Parish, Maynard Jensen, Bernice Parish, Orville Wright, Maxine Olsen, Evelyn Larson.

Second row: LaRue Jensen, Ralph Parish, Arlene Jensen, Dorothy Wright

Third row: Nellie Voss (teacher), Dorothy Parish, Marvin Parish, Maurice Finn, Irene Christiansen, Marl Wright.





### 1 - Left Third of 1926 Parish School PTA Photo

**Etta Parish** (17), d/o **Elmer & Tillie Parish**, m. Herman Johnson in 1932, m. Henry Dannat.

**Matilde "Tillie" (Peters) Parish** (37) and **Elmer Parish** (40).

**Daisy (Welbourn) Willmott** (42), holding hat, widow of James Willmott.

**Ernest Hough** (37), bachelor, m. Bessie Olsen in 1937.

**James Olsen** (28), in rear, husband of **Sadie Olsen**.

**Esther (Larsen) Finn** (37), in profile, widow of Peter Finn, m. Joel Raymond "Ray" Wright in 1936.

**Sadie (Willmott) Olsen** (age abt 23), d/o Daisy Willmott and wife of **James Olsen**.

**Lydia (Jacobsen) Christensen** (37) and **Chris K. Christensen** (38).

**Ellen (Hansen) Larson** (38) and **Henry Larson** (49).

**Leslie Handlen** (26), s/o **Frank & Sarah Handlen**, m. Edna Jensen in 1930.

**Walter Jacobsen** (38), holding cap, brother of **Lydia Christensen**, never married.

**Lynn Handlen** (22) or possibly Vere Handlen (30), s/o **Frank & Sarah Handlen**.





## 2 - Middle of 1926 Parish School PTA Photo

**Lynn Handlen** (22) or possibly **Vere Handlen** (30), s/o **Frank & Sarah Handlen**.

**Rozel Parish** (42) and **Mary (Jensen) Parish** (37).

**Frank Handlen** (60), with mustache, and **Sarah (Parish) Handlen** (55).

**Christine (Hansen) Jensen** (42), widow of Chris Jensen.

**Mary E. (Orr) Hukill** (61), in rear, wife of Charles Hukill.

**Maxine Olsen** (7), d/o **James & Sadie Olsen**, never married.

**Bernice Parish** (5), d/o **Rozel & Mary Parish**, m. Everett Smith in 1938.

**Mildred Beedle** (10), d/o John Beedle & the late Emma Olsen, m. William R. Graves.

**Marvin Parish** (12), s/o **Rozel & Mary Parish**, m. Alice Driver in 1937.

**Maurice Finn** (12), s/o **Esther Finn**, m. Margaret Seidler.

**Ervin Jensen** (15), tall boy, s/o **Christine Jensen**, m. Minnie Christoffersen in 1945.

**Dorothy Parish** (15), d/o **Elmer & Tillie Parish**, m. George Grisson in 1935; m. Walter Hone.

**Blanche Parish** (15), d/o **Rozel & Mary Parish**, m. Marvin Moffatt in 1931.

**Pearl Parish** (6), d/o **Elmer & Tillie Parish**, m. Mr. Lininger.





### 3 – Right Third of 1926 Parish School PTA Photo

**Pearl Parish** (6), d/o **Elmer & Tillie Parish**, m. **Mr. Lininger**.

**Maynard Jensen** (6), hands in pockets, s/o **Henry & Tina Jensen**, m. **Gladys Sorensen**, m. **Ruby Massie & m. Thelma (Schroder) Larson** in 1986.

**Arlene Jensen** (9), d/o **Chris & Christine Jensen**, m. **Henry Ericksen** in 1940.

**Ralph Parish** (10), s/o **Rozel & Mary Parish**, m. **Phyllis Geise** in 1941.

**Evelyn Larson** (8), d/o **Henry & Ellen Larson**, m. **Lewis Rhode** in 1939; m. **Philip Sherbondy** in 1958.

**Tina (Nelsen) Jensen** (age abt 37), in rear, wife of **Henry Jensen**.

**LaRue Jensen** (9), d/o **Henry & Tina Jensen**, m. **Frederick Baraks/Barracks**.

**Richard Olsen** (3), little boy, s/o **James & Sadie Olsen**; m. **Marjorie Allen** in 1945.

**Henry Jensen** (35), tall man in back.

**Edna McKeown** (12), niece of **Mrs. Daisy Willmott**.

**Milton Jensen** (20), s/o **Chris & Christine Jensen**, m. **Lillie Larsen** in 1938.

**Nellie Voss**, teacher (24), m. **Howard Smith & m. David Mackland**.

**Walter Hukill** (19), s/o **Charles & Mary E. Hukill**, m. **Ethel Kendrick**.

**Lorene Parish** (18), d/o **Rozel & Mary Parish**, m. **Lawrence C. Larsen** in 1928.

**Hans Peter Hansen** (44), brother of **Ellen Larson**, never married.



## The Parish School PTA Photo Family Sketches

### \*\*\*\*\* The Christensen/Jacobsen Family:

#### Chris K. and Lydia (Jacobsen) Christensen

**Chris Knudsen "Chris K." Christensen** (17 or 19 May 1888 - 31 Jan 1945) was the son of Lars Hansen Christensen and Laurentine Christine Christensen who had earlier lived in Hazel Dell Township, Section 16 before retiring to Council Bluffs. Chris K. first married Anna M. Nelson from Avoca who died from complications of childbirth.

**Lydia Anna Jacobsen** (6 Jan 1889 - 3 Aug 1971) was the daughter of Jens C. Jacobsen and Christine Marie "Marie" Gronbeck of Hazel Dell Township, Section 9.

Chris K. and Lydia farmed her parents' home place in Hazel Dell Township, Section 9 until about 1940 when Vernon Larson acquired this farm. Chris K. and Lydia were childless but were foster parents to the Banther twins, Paul and Pauline.

**Walter Jacobsen** (1 Jun 1887 - 5 Mar 1971) was the brother of Lydia (Jacobsen) Christensen. Walter never married and farmed in Hazel Dell Township, Section 9 until 1950 when he retired and moved to Council Bluffs.

Chris K. and Lydia Christensen and Walter Jacobsen appear on the 1926 Parish School PTA photo.

Chris K. and Lydia Christensen and Walter Jacobsen, along with Chris K.'s first wife, are buried at St. Paul's Lutheran Church in Boomer Township.

### \*\*\*\*\* The Finn Family:

**Esther (Larsen) Finn** (22 May 1888 - Dec 1970) was born in Iowa to L. C. Larsen and Mary Petersen who had emigrated from Denmark. She married Peter Finn in Tacoma, Washington in 1912 and their one child, Maurice, was born the following year. In 1914 she and her son, Maurice, returned to Iowa where she worked as a housekeeper with families in Hazel Dell Township. She was working in the Nels and Maggie Peterson household in 1920 and was housekeeper in the Morris Hough household in 1925 and 1930.

Esther (Larsen) Finn married Joel Raymond "Ray" Wright, the son of Frederick Wright and Frances Hough of Hazel Dell Township, Section 3, in 1936 and settled on the Wright farm. Raymond Wright died in 1942 and in 1949 the Wright farm was sold to Stella Chapman.

Maurice Finn appears on the c. 1925 photo and Esther and Maurice both appear on the 1926 Parish School PTA photo.

**Maurice J. Finn** (14 Jul 1913 - Jun 1980) was born in Tacoma, Washington and raised in Hazel Dell Township. He married Margaret Seidler, the daughter of Frank Seidler Sr. and Edna Garner of Garner Township. By 1940 he owned and was farming his step grandfather's farm, the Frederick Wright home place in Hazel Dell Township, Section 3.

He became an agent for Farm Bureau Mutual Insurance Company and by 1949 was living on McPherson Avenue in Council Bluffs.

Joel Raymond and Esther Wright are buried in Walnut Hill Cemetery in Council Bluffs. Maurice Finn is buried in St. Joseph Cemetery in Council Bluffs.

\*\*\*\*\* **The Handlen Family:**

**Franklin Ferris "Frank" Handlen** (21 Sep 1865 - Apr 1961), the son of Thomas Handlen and Leah Jones, was born in Montmorenci, Tippecanoe County, Indiana or in Boone County, Indiana.

**Sarah Adelia Parish** (29 Sep 1870 - 1947) was the daughter of Delorma Parish and Elethe Jane Hall. Sarah Adelia (Parish) Handlen and Rozel Parish were siblings, and were first cousins of Elmer Parish.

Frank and Sarah Handlen lived in Hazel Dell Township, Section 9 and are buried at the Grange Cemetery in Boomer Township, as is Frank's father, Thomas Handlen. Their children were Leah E., Vere P., Leslie C., Lynn T., and Lora Mae (died as a toddler). Frank, Sarah, and two of their three sons appear in the Parish School PTA photo.

**Leslie C. Handlen** (14 Jun 1899 - 22 Jan 1968) married Edna Jensen, the daughter of James C. Jensen and Fannie C. Johnson who at one time lived in Hazel Dell Township, Section 11. Leslie and Edna Handlen had two daughters and lived in Hazel Dell Township and Neola Township before moving to Council Bluffs. Leslie and Edna Handlen are buried in the Hazel Dell Cemetery.

Vere P. Handlen (19 Apr 1896 - 8 Dec 1986) married Helen Metilena Julius, the daughter of Anton F. Julius and Maria Christine Mikelsen. (Anton Julius was a grocer in Weston, Iowa around 1900, and lived in Underwood briefly before moving to McClelland, Iowa.) Vere and Helen Handlen are buried in the Downsville Cemetery south of Underwood, Iowa.

Lynn T. Handlen (16 Mar 1904 - Dec 1984) married Leona Agnes Hansen, daughter of John Alexander Hansen and Annie L. Rasmussen of Hazel Dell Township, Section 14. Lynn and Leona Handlen had three daughters. Lynn and Leona Handlen are buried in the Hazel Dell Cemetery.

\*\*\*\*\* **The Hansen Family:**

**Henry Larson** (15 Apr 1877 - 12 Feb 1957) was the son of Neils Larsen and Maren Larsen of Hazel Dell Township Section 15.

**Ellen Marie Hansen** (27 Dec 1887 - 25 Jun 1982) was the daughter of Peter Hansen and Dorthe Hansen of Hazel Dell Township, Section 10.

Henry and Ellen Larson lived in Hazel Dell Township Section 10. Their children were Evelyn Dorothy and Donald Robert, who died in infancy. Evelyn appears in the c. 1925 photo. Henry, Ellen and Evelyn appear in the 1926 Parish School PTA photo.

**Evelyn Dorothy Larson** (12 May 1918 – 10 Apr 2011) married Lewis Rhode and later married Philip Sherbondy. She lived in Council Bluffs, then in a dome house in Hazel Dell Township west of Underwood, and around 1990 moved to Council Bluffs. She was a retired special education teacher and the mother of seven children.

**Hans Peter "Pete" Hansen** (4 Apr 1882 - 25 Jun 1959) was the brother of Ellen (Hansen) Larson. He never married. He remained at his home place in Hazel Dell Township, Section 10 renting land from the Graham estate until he retired from farming in the 1940s. He spent his final years in Council Bluffs. Pete Hansen appears in the 1926 Parish School PTA photo.

Henry and Ellen Larson, Evelyn (Larson) Sherbondy, and Hans Peter Hansen are all buried at St. Paul's Lutheran Church in Boomer Township.

**Footnote:** Henry Larson's brother, Andrew, married Ellen Hansen's sister, Karen Margrethe "Maggie". Andrew and Maggie Larson lived their entire married life in Hazel Dell Township, Section 15. They were the parents of nine children (one being my mother) who attended Hazel Dell #5, two miles south of the Parish school, and are also buried at St. Paul's.

\*\*\*\*\* **The Hough Family:**

**Ernest W. Hough** (25 Jan 1889 - 22 Jan 1962) was the son of Morris A. Hough and Sarah Ellen Hall of Hazel Dell Township, Section 10. In 1937 Ernest married Bessie Olsen, the sister of James Olsen who appears in the 1926 Parish School PTA photo.

Ernest and Bessie Hough are buried at the Grange Cemetery in Boomer Township.

\*\*\*\*\* **The Hukill Family:**

**Charles E. Hukill** (9 Dec 1863 – 2 Dec 1936) was the son of Henry Harrison Hukill and Mary Ann Wise who lived in Indiana. Charles Hukill is not on the Parish School PTA photo.

**Mary Ellen Orr** (22 Feb 1865 – 22 Jul 1953) was the daughter of John Orr and Maria Gray of Ripley County, Indiana. Several of her siblings lived in the Hazel Dell or McClelland, Iowa area.

Charles and Mary Ellen Hukill came to Pottawattamie County about 1914. They first lived in Hardin Township and then moved to Hazel Dell Township, Section 10, where they rented from the Graham estate. They lived east of the road with their driveway between the Henry Larsen driveway and the Hans Peter Hansen driveway.

In the late 1920s the Hukill family moved to Dawes County in western Nebraska. Charles and Mary Ellen are buried in Greenwood Cemetery in Chadron, Nebraska.

Charles and Mary Ellen Hukill's children were Meredith O., Lucille L., Ina M., Charles W., Walter E., and twins Elma I. and Elva I. Mary Ellen Hukill and son Walter appear in the 1926 Parish School PTA photo.

**Walter E. Hukill** (11 Aug 1906 – Oct 1985) moved to Nebraska with his parents. He married Ethel L. Kendrick. He died in Perkins County, South Dakota and is buried in Greenwood Cemetery in Chadron.

\*\*\*\*\* **The Jensen Families:**

\*\*\* **Christian and Christina (Hansen) Jensen**

Christian M. "Chris" Jensen (8 Jul 1883 - 30 Apr 1924) was the son of Jacob Jensen and Anna Dorthea Madison of Boomer Township, Section 28. He was deceased before this photo.

**Hansine Marie Christina "Christina" Hansen** (9 Dec 1883 - 1 Nov 1954) was the daughter of Peter Hansen (also known as "Pigeon Pete" and Nielsine Jensen of Neola Township, Section 19.

Chris and Christina Jensen lived about a half mile west of the Parish School in Hazel Dell Township, Section 9 and are buried at St. Paul's Lutheran Church in Boomer Township.

Chris and Christina Jensen's children were Milton, Violet, Erwin, and Arlene. Arlene appears on the c. 1925 photo. Christina and her children Milton, Erwin, and Arlene appear on the 1926 Parish School PTA photo. The fourth child, Violet, married Rudolph Jensen and lived in Boomer Township.

**Milton Sylvester Earl Jensen** (10 Mar 1906 - Aug 1979) married Lillie Marie Larsen, the daughter of Jens Peter "James" Larsen and Karen Marie Christensen of Ringsted, Emmet County, Iowa who had earlier lived in Weston, Iowa.

Milton and Lillie Jensen had four daughters. Milton and Lillie Jensen are buried in Cedar Lawn Cemetery in Council Bluffs, Iowa.

**Erwin Maynard Orville Jensen** (4 Nov 1910 - 1 Jul 1995) married Minnie Marie Christoffersen, the daughter of Martin Christoffersen and Minnie Bondo of Neola Township.

Erwin and Minnie Jensen lived in Hazel Dell Township Section 11 about a mile and a half east of the Parish School. Erwin and Minnie had no children. Erwin and Minnie Jensen are buried at St. Paul's Lutheran Church in Boomer Township.

**Arlene Bernice Levine Jensen** (4 Nov 1916 - 26 May 2001) married Nels Henry "Henry" Ericksen, the son of Elias Ericksen and Johanna Thode of Neola Township, Section 31.

Henry and Arlene Ericksen had three children and lived about seven miles east of McClelland in Washington Township, Section 3. Henry and Arlene Ericksen are buried at St. Paul's Lutheran Church in Boomer Township.



### **\*\*\* The Jensen Families (continued) Henry and Tena (Nelsen) Jensen**

**Henry John Jensen** (12 Jun 1890 - 30 Mar 1938) was the son of John Jensen and Nora Madison of Hazel Dell Township, Section 9.

**Tena Marie Nelsen** (1889 - 15 Mar 1931) was the daughter of Andrew C. Nelsen and Ane Kirstine "Stena" Olesen who lived in the Avoca, Iowa area.

Henry and Tena Jensen lived in Hazel Dell Township, Section 9 on his parents' home place and are buried at St. Paul's Lutheran Church in Boomer Township. Their children were LaRue, a twin, Lucille (who died as a toddler), and Maynard. LaRue and Maynard appear on the c. 1925 photo. Henry, Tina, LaRue and Maynard all appear on the 1926 Parish School PTA photo.

**LaRue Viola Jensen** (17 Dec 1916 - Oct 1990) married Frederick "Bud" Baraks and lived in Rock Island, Illinois.

Frederick Baraks was killed in Europe near the end of World War II and is buried in the military cemetery in Saint Avold, Lorraine, France with his surname given as "Barracks". LaRue (Jensen) Baraks is buried in the Rock Island, Illinois National Cemetery. Frederick and LaRue Baraks had two sons.

**Maynard Henry Jensen** (6 Mar 1920 - 29 Jan 1998) married Gladys I. Sorensen, the daughter of Chris Sorensen and Mary Christensen who lived in northwestern Hazel Dell Township.

Maynard Jensen served in the Army Air Force during World War II. Maynard and Gladys lived in Council Bluffs where he was a driver for Beatrice Foods. Maynard and Gladys had two sons, one of whom, Dennis, died in Vietnam at the age of 19.

After Gladys' death, Maynard married Ruby Massie. After Ruby's death, Maynard married Thelma Mae (Schroder) Larson, the daughter of Henry Schroder and Jessie Shadden and the former wife of my uncle, Vernon Larson. Maynard and Thelma lived in Hazel Dell Township, Section 15 in what in 2013 is the residence of Rick and Cheryl Larson. Maynard Jensen is buried with his first wife at Cedar Lawn Cemetery in Council Bluffs, Iowa.

Christian M. Jensen and Henry Jensen, the heads of the two Jensen families pictured, were related thusly: Christian's mother, Anna Dorthea (Madison) Jensen, and Henry's grandfather, John Madison, were siblings.

\*\*\*\*\* **The Olsen Family and Relatives:**

James A. Willmott (1878 or 1879 - 1917) was the son of John R. Willmott and Sarah Williams of Neola Township, Section 18. He was deceased before this photo.

**Daisy (Welbourn) Willmott** (19 Oct 1883 – 6 Mar 1949), the widow of James A. Willmott was the daughter of Joseph Welbourn and Nancy Jane Powell of Neola Township, Section 30. James and Daisy Willmott are buried at the Grange Cemetery in Boomer Township.

**James A. Olsen** (5 Jul 1897 - May 1963) was the son of Peter Olsen, Jr. and Anna Peterson of Hazel Dell Township, Section 8.

**Sarah Jane "Sadie" Willmott** (abt 1903 - \_\_\_\_\_) was the daughter of James A. Willmott and Daisy Welbourn.

James and Sadie Olsen lived in Hazel Dell Township, Section 4 in 1926, later lived just north of Neola, lived west of Avoca in the late 1940s, and then lived in Council Bluffs.

James and Sadie Olsen's children were Maxine L., Richard J., Beulah J., and Harold. Maxine appears in the c. 1925 photo. James, Sadie, children Maxine and Richard, and Sadie's mother Daisy, appear in the 1926 Parish School PTA photo. Also on the photo are Mildred Beedle and Edna McKeown. Beulah and Harold Olsen were not yet born.

**Maxine L. Olsen** (27 Apr 1919 – 27 Dec 1995) never married.

**Richard J. Olsen** (13 May 1923 – 28 Feb 2005) married Marjorie Allen daughter of Harry Allen and Anna Peck of Avoca, Iowa.

Richard and Marjorie first lived near his parents west of Avoca, Iowa and then lived in York Township, Section 7 just northeast of Bentley, Iowa. Richard and Marjorie Olsen had five children. Richard is buried in Memorial Park Cemetery in Council Bluffs.

**Mildred Eileen Beedle** (15 Apr 1916 – 19 Jul 1999), was the daughter of John Beedle and Sarah Emma "Emma" Olsen (Mar 1893 - 1918), who was James Olsen's sister. Mildred's mother died when Mildred was a baby and Mildred's father died while Mildred was a teenager. Subsequently Mildred's Olsen grandparents adopted her. Mildred appears in the 1926 Parish School PTA photo.

Mildred married William R. Graves and was in McAlester, Oklahoma in 1944. Later William and Mildred lived in Council Bluffs and ran the Hybrid Sales Company. In 1979 William Graves died and Mildred subsequently married Oscar Smith of Sioux City. William and Mildred Graves had one child who settled in Naperville, Illinois, where Mildred died.

**Edna McKeown** (31 Jul 1913 – 23 Aug 1937) was a niece of Mrs. Daisy Willmott. She was the daughter of Eli and Josephine (Welbourn) McKeown who lived in Hazel Dell Township, Section 8. Their children were Joseph Earl, Hilda M., Helen L., and Edna B.

Edna may have married a Mr. Kerns before her early death. She is buried in the Grange Cemetery in Boomer Township.

\*\*\*\*\* **The Parish Families** (Headed by first cousins Elmer and Rozel Parish. Rozel's sister, Sarah Adelia (Parish) Handlen, appears earlier in the Handlen section. Elmer's sister, Etta, appears at the end of this section.)

\*\*\* **Elmer and Tillie (Peters) Parish**

**Elmer Elida Parish** (22 Sep 1885 - 22 Apr 1965) was the son of Elida Parish and Jane Tucker Nelson of Hazel Dell Township, Section 3.

**Matilda M. "Tillie" Peters** (10 Jan 1889 - 22 Apr 1965) was the daughter of William Peters and Margaret Armstrong of Boomer Township, Section 15.

Elmer and Tillie Parish had lived in Hazel Dell Township after marrying, moved to Lincoln County, Nebraska near North Platte around 1920, and returned to Hazel Dell Township before 1925 where they lived on his parents' home place in Section 3. They were living in Nodaway County in northwestern Missouri in 1935 and in Oak Township, Mills County, Iowa in 1940. Later they lived in Council Bluffs.

Elmer and Tillie Parish are buried at the Grange Cemetery in Boomer Township. Their children were Etta, Dorothy, Pearl and Inas.

Dorothy and Pearl appear in the c. 1925 photo. Elmer, Tillie, and children Etta, Dorothy, and Pearl appear in the 1926 Parish School PTA photo.

Elmer and Tillie's youngest child, Inas, who wasn't born until 1930, married a Mr. Basch and lived in Council Bluffs.

**Etta Matilda Parish** (15 Mar 1909 – 3 Jun 1965) married Herman Johnson in 1932 and then married Henry Dannat. Etta and Henry Dannat are buried at the Grange Cemetery in Boomer Township.

**Dorothy Jane Parish** (7 Dec 1910 – 6 Sep 1989) married George Grisson in 1935 and later married Walter Hone from Ohio. She and Walter lived in Mercer County, Ohio, perhaps from before 1940 until their deaths.

**Pearl Ione Parish** (17 Dec 1919 – 2 May 1974) married John Austin Lininger in 1937. Pearl and John Lininger were living in Nodaway County, Missouri in 1940, and evidently remained in Nodaway County until their deaths. They are buried in Hillcrest Cemetery, Skidmore.

\*\*\* **Rozel and Mary (Jensen) Parish**

**Rozel Delorma Parish** (8 Jul 1883 - 1940) was the son of Delorma Parish and Elethe Jane Hall of Hazel Dell Township, Section 3.

**Mary Jensen** (24 Jul 1888 - 23 Dec 1973) was the daughter of Niels Jensen and Elsie Marie Christensen. Niels Jensen died in 1894, leaving Elsie with six children. Elsie lived in Hazel Dell Township until marrying John Frederick Drebis and moving to Washington State in 1914.

Rozel and Mary Parish lived in Hazel Dell Township, Section 3, on his parents' home place. They are buried in the Grange Cemetery in Boomer Township. Their children were Lorene, Blanche, Marvin, Ralph, Bernice, and William who died in infancy.

Marvin, Ralph and Bernice appear in the c. 1925 photo. Rozel, Mary, and all five of their surviving children, Lorene, Blanche, Marvin, Ralph, and Bernice appear in the 1926 Parish School PTA photo.

**Lorene Bessie Parish** (30 Nov 1907 - Apr 1979) married Lawrence C. Larsen. Lawrence and Lorene lived in various locations on the Pottawattamie County area. At one time Lawrence worked for the Council Bluffs Hatchery. Lawrence and Lorene Larsen had seven children.

**Blanche Elsie Parish** (6 Jul 1910 - 16 Jun 2000) married Marvin Arlington "Scrap" Moffatt, the son of George Arthur Moffatt and Margaret Selma Hansen of Neola Township, Section 8.

Marvin and Blanche Moffatt lived west of Neola in Neola Township, Section 29 for many years. Their farm had been part of the Thomas Spencer home place, and later the farm of the oldest Spencer son, George Washington Spencer.

Marvin and Blanche did not have children. They moved to Council Bluffs about a year before Marvin's death. Blanche and Marvin Parish are buried in the Cedar Lawn Cemetery in Council Bluffs.

**Marvin Rozel Parish** (5 Aug 1913 - 12 Jun 1969) married Alice E. Driver, the daughter of Edwin Driver and Anna Christiansen of Boomer Township, Section 21.

Marvin and Alice Parish had three children and lived a few miles southeast of Underwood in Norwalk Township Section 26. Marvin and Alice Parish are buried in the Cedar Lawn Cemetery in Council Bluffs.

**Ralph Delorma Parish** (28 Aug 1915 - 25 Jan 1968) married Phyllis Louise Geise, the daughter of Philip Edwin Geise and Louise Sophia Geise of Norwalk Township, Section 16, just east of Underwood.

Ralph and Phyllis Parish had three children and remained in the Underwood area. They are buried in the Cedar Lawn Cemetery in Council Bluffs.

**Bernice Hope Parish** (11 Oct 1920 – 13 Nov 1987) married Everett Leroy Smith, the son of William A. Smith and Julia Marie Jensen of Boomer Township, Section 26.

Everett and Bernice Smith had at least three children and lived in California. They may have died in Carson City, Nevada.

\*\*\* Alfred B. and Etta Ann (Parish) Christensen

**Alfred B. Christensen** (18 Mar 1887 – abt 5 Aug 1952) was born in rural Underwood to Christen Christensen and Kirsten "Katie" Madsen and may have been raised in Council Bluffs.

**Etta Ann Parish** (13 Apr 1881 – 17 Jul 1973) was born in Hazel Dell Township to Elida Parish and Jane Tucker Nelson.

Alfred and Etta farmed in Boomer and northern Hazel Dell Townships before moving to Council Bluffs after 1925. Alfred and Etta had two children, Harold who drowned as a teenager and Irene who is pictured on the c. 1925 photo.

**Irene B. Christensen** (4 Apr 1914 – Apr 2001) cared for her mother until her mother's death in 1973. Then Irene cared for my stepmother, Lila Ferne (Spencer) Bertelsen Christiansen, during Ferne's final illness. Subsequently Irene married Virgle Vogt.

\*\*\*\*\* **Adolph Benjamin Wright and Martha Cathrine Jorgensen**

**Adolph Benjamin Wright** (9 Jul 1884 – 2 Aug 1962) was born in northern Hazel Dell Township to George Wright Jr. and Alice Emma Gilson.

**Martha Cathrine Jorgensen** (Aug 1892 – 13 Jan 1968) was born in Nebraska to Andrew Jorgensen and Laura Christina Heiberg, recent immigrants from Denmark, and came to Pottawattamie County with her parents as a child.

Adolph and Martha married in 1913 and lived on Wright land in extreme northern Hazel Dell Township. In the late 1920s they moved to Rockford Township and by 1940 were living in Council Bluffs.

Adolph and Martha Wright had four children, Marl, Dorothy, Orville and Benjamin. Marl, Dorothy and Orville appear on the c. 1925 photo.

**Marl Manning Wright** (2 Jul 1914 – 18 Mar 1994) married Alice Fern McCauley.

**Dorothy Wright.** I have no further information.

**Orville R. Wright** (22 Sep 1918 – 17 Jul 2000) married Anita Bahnsen. Orville and Anita had four children and in 1967 were living in southwestern Hazel Dell Township.



\*\*\* **Nellie Voss** (30 Aug 1901 - May 1966), the Parish School teacher at the time, appears in both the c. 1925 photo and the 1926 Parish School PTA photo. Nellie was, the daughter of Fredrick C. Voss and Margaret Rebecca Rebehn of Boomer Township, Section 3.

Nellie married Howard D. Smith, the son of George R. Smith and Dora Parish of Boomer Township, Section 34, around 1926. Howard and Nellie Smith's children were Gene and Harvey. Howard Smith died in 1931.

About 12 years after Howard's death, Nellie married Joseph David "David" Mackland, the son of Joseph Mackland and Louisa Jane Price of Boomer Township, Section 35. After their marriage, David and Nellie Mackland lived in Missouri Valley, Iowa.

Nellie (Voss) Smith Mackland and both her husbands are buried at the Grange Cemetery in Boomer Township.

Nellie Voss's sisters, Hilda and Helen, both taught at the nearby Center School, Hazel Dell #5.