

## Reel's Cemetery in Boomer Township

Version 0 © 2016 by Robert A. "Bob" Christiansen, updated by RAC 15 Jul '16.

<b>Contents</b>	<b>page</b>
About This Report	2
Contacting Me	2

### Maps

Pottawattamie County Maps	3
Brief Reel's Cemetery History	5

### Sources

Sources for This <i>Reel's Cemetery</i> Report	6
Reel's Cemetery - On-Line Biographies and Obituaries	7

### Groups Represented in the Reel's Cemetery Burials

• The First Mormons - 1846 and 1847	10
• Settlers from Central Indiana - beginning in the early 1850s	12
The Reel Family	14
• The Later Mormons - beginning in the early 1850s	17
The McMullen Family	20
• The North Germans - beginning in the mid 1860s	25
The Rief Family	27
• The Danes - beginning about 1867	32
• Other Reel's Cemetery Burials	33

### Notes

Notes - Reel's Cemetery Burials in My <i>St.Paul's</i> Database	34
Notes - Reel's Cemetery Burials Not in My <i>St.Paul's</i> Database	35
Notes - The Wives of Reel's Cemetery	37
<b>Reel's Cemetery Burials Found in the <i>St.Paul's</i> Database</b>	<b>38</b>

Reel's Cemetery, inactive for many years, is located north of Council Bluffs in Pottawattamie County Iowa, in the southwestern corner of Boomer Township. I have included some maps for those not familiar with this area.

Those buried in Reel's Cemetery represent several waves of early settlement in Rockford, Crescent, Boomer and Hazel Dell Townships. As indicated above, I have divided early settlers into groups, with additional information for the families most representative of the three largest groups, namely the Reel, McMullen and Rief families.

## About This Report

I spent my first twelve years on my grandparents' farm about three miles northeast of Reel's Cemetery. I first learned of this historic cemetery from my father, but did not visit it until my friend, Derald Blois, and I parked along rural 190th Street and trudged up the hill around 2000. One of my recollections is the abundant growth of poison ivy!

Apparently the Reel's Cemetery books were destroyed before 2000, perhaps because since the 1930s the cemetery had witnessed no burials. This is a shame, since the few miles around Reel's Cemetery have seen so much history, history that I am trying to record and report in the time remaining to me. We can learn much of the American experience in the 1800s from the stories of the families buried in this cemetery.

In 1984 the Botna Valley Genealogical Society in eastern Pottawattamie County read the Reel's Cemetery stones and produced a publication that is still available from the Iowa Genealogical Society. More recently, individuals such as Julie Ryan photographed some of the stones and made entries for individual burials in findagrave.com.

In June 2016 Julie and Tom Ryan made the distressing discovery that Reel's Cemetery had been badly vandalized. Their sad report appeared in the Council Bluffs *Nonpareil* on June 11th. In response to the *Nonpareil* article, I used my *St. Paul's* database along with additional Internet research to hurriedly assemble the initial version of this report.

To view the initial version of this report on-line as of 11 Jul '16:

- Access the website *kirstenpedersen.weebly.com*.
- Under the *Maggie's World* item in the main menu, select *Maggie's Neighborhood*.
- This should open the *Maggie's Neighborhood - Preface* page, which contains lists of local history reports, most dealing with northwestern Pottawattamie County, Iowa. This report is named *Reel's Cemetery*.

## Contacting Me

My initial version of this report is bound to contain errors - Please report them to me at your first convenience. Also I would appreciate hearing from others who could help with the early history of rural northwestern Pottawattamie County.



## Pottawattamie County, Iowa Maps

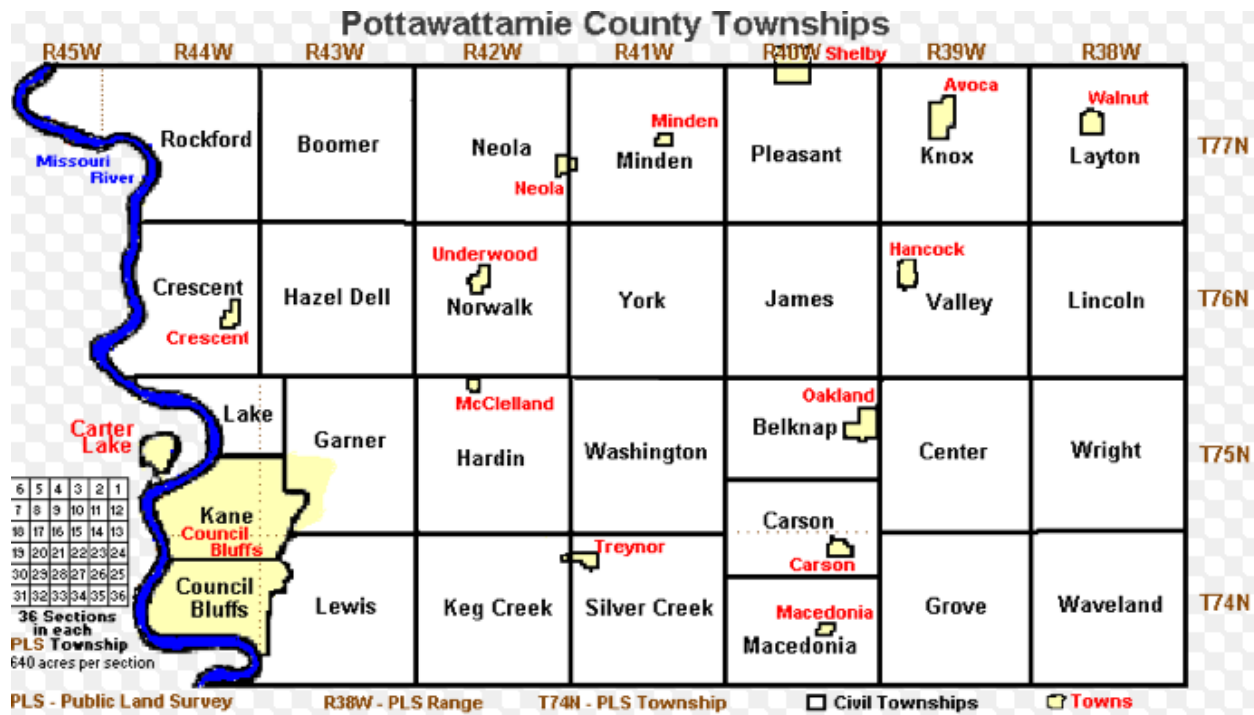

### ***Townships and Towns in Pottawattamie County, Iowa***

Courtesy of [iagenweb.org/pottawattamie](http://iagenweb.org/pottawattamie)

Reel's Cemetery, in the southwestern corner of Boomer Township, is located near Rockford, Crescent and Hazel Dell Townships. I am interested in the early history of the area within these rural townships.

- Rockford Township was organized in 1853 and originally included all of northwestern Pottawattamie County.
- Crescent Township was split off from Rockford Township in 1857.
- Boomer Township was split off from Rockford Township in 1858 and originally included part of today's Neola Township.
- Hazel Dell Township was split off from Crescent Township in 1872.

Not shown on the above map are the following villages:

- Honey Creek in southeastern Rockford Township.
- Loveland in northeastern Rockford Township.
- Weston in southeastern Hazel Dell Townships.

The following map shows the area around Reel's Cemetery. Reel's Cemetery is located near the "3" in the "31" section number in the top left.



**Portion of Northwestern Pottawattamie County**

courtesy of <http://www.iowadot.gov/maps/msp/pdf/pottawattamie-bwco.pdf>

## Brief Reel's Cemetery History

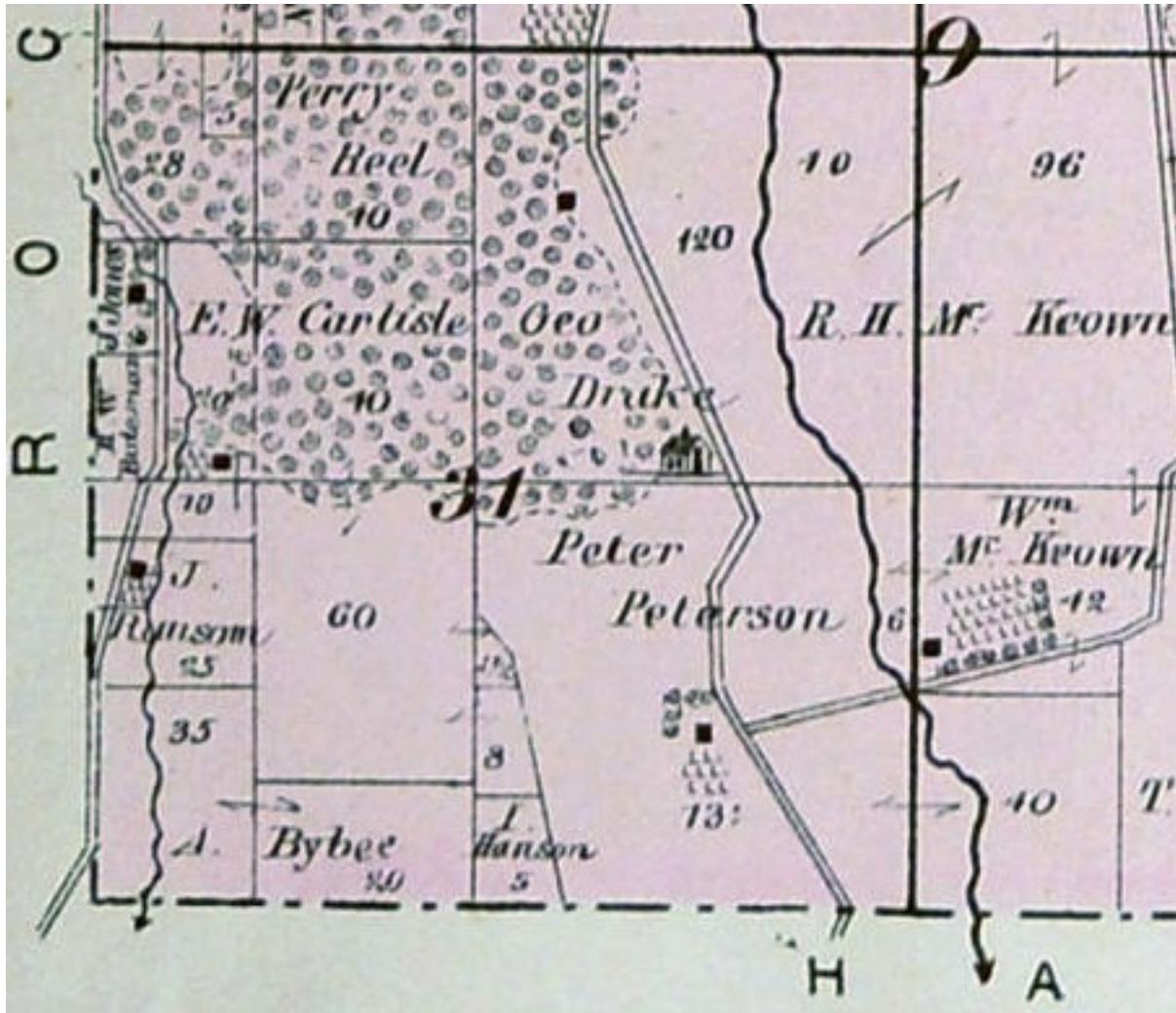

### **Boomer Township, Section 31 in 1885**

from the 1885 Allen *Illustrated Atlas of Pottawattamie County*  
courtesy of digital.lib.uiowa.edu

Reel's Cemetery was established in Boomer Township, Section 31 in the 1850s, has over 1390 burials, and has been inactive for many years. Unfortunately the cemetery records are lost and Reel's Cemetery was heavily vandalized in 2016.

The above plat does not show Reel's Cemetery. The Botna Valley Genealogical Society publication cited in the Sources section gives the location as

SE 1/4 of NE 1/4 of SW 1/4 of Section 31, Township 77N, Range 43W.

On the above plat North Pigeon Creek is shown lying between the Peter Peterson and William McKeown farmsteads. Note the schoolhouse at the south end of the George Drake farm.



## Sources for the *Reel's Cemetery* Report

- The immediate source for this report is my *St. Paul's* database, which contains brief biographical information for over 35,000 individuals whose families had some connection with the northwestern Pottawattamie County, Iowa area. All but six of the individuals believed interred in the Reel's Cemetery are represented in my *St. Paul's* database.
- I have written substantially about early northwestern Pottawattamie County and especially the Danish settlers in the Boomer Township area. Most of this material is now on-line, with links in the *Maggie's World* area of [kirstenpedersen.weebly.com](http://kirstenpedersen.weebly.com).

The *Pottawattamie County History on the Internet* section of *Pottawattamie County, Iowa - An Historical Overview* lists the major on-line sources for Pottawattamie County, some of which I used for my Reel's Cemetery report.

- In 1984 members of the Botna Valley Genealogical Society read the Reel's Cemetery gravestones. Their results, combined with the results from other two small Boomer Township cemeteries, St. Bridget and St. Paul's Lutheran, are found in cemetery publication number 0871, available from the Iowa Genealogical Society in Des Moines. The results from Boomer Township's much-larger Grange Cemetery are in a separate cemetery publication, number 0864.

### On-line Cemetery Sites:

- findagrave.com entries for Reel's Cemetery (<http://www.findagrave.com/cgi-bin/fg.cgi?page=cr&CRid=981712>). As of 14 Jun 2016 findagrave.com listed 140 interments for Reel's Cemetery, with 66% photographed (some interments are duplicates).
- iowagravestones.org has 18 records for Reels Cemetery, the most-recent added in 2011. All are probably also in findagrave.com.
- For the record, billiongraves.com seems to have zero entries for the Reel's Cemetery.

### Pottawattamie County historical and genealogical information sites:

- IowaGenWeb project for Pottawattamie County: <http://iagenweb.org/pottawattamie>
- Pottawattamie County Genealogical Society: <http://www.rootsweb.ancestry.com/~iapcgs>
- Pottawattamie County Genealogy Trails Project (the cemetery section includes links to some Reel's Cemetery obituaries): <http://genealogytrails.com/iowa/pottawattamie>
- Historical Society of Pottawattamie County: <http://www.thehistoricalsociety.org>

### Pottawattamie County historical and biographical books:

- **Baskin** - 1883 *Baskin History of Pottawattamie County, Iowa*, available at [books.google.com](http://books.google.com).

- **Lewis** - 1891 *Lewis Biographical History of Pottawattamie County, Iowa*, available at [books.google.com](http://books.google.com). There is an index at <http://homepages.rootsweb.ancestry.com/~gonfishn/bhopci/>
- **Field** - 1907 *History of Pottawattamie County, Iowa from the Earliest Historic Times to 1907*, available at [books.google.com](http://books.google.com) (two volumes). You can find an index at [https://dcms.lds.org/delivery/DeliveryManagerServlet?dps\\_pid=IE951186](https://dcms.lds.org/delivery/DeliveryManagerServlet?dps_pid=IE951186)

#### Other Sources:

- Published Boomer Township plats don't seem to show Reel's Cemetery. However, the legal description of the Reel's Cemetery location given earlier is confirmed by a Boomer Township plat drawn about 1890 by my grandfather, James P. Christiansen, when he was township assessor.
- Current Pottawattamie County road map:  
<http://www.iowadot.gov/maps/msp/pdf/pottawattamie-bwco.pdf>
- *Two families from Boomer: the history and genealogy of the families of Peter and Rachel Cady Peterson, and of Captain Thomas and Martha Evans Thomas of Boomer township, Pottawattamie County, Iowa* by Earl Thomas Peterson; Glen James Peterson; Shirley Griebeling Peterson, 1982, 318 pp. As of Jun 2016 I can't find this on-line. It is available at the Family History Center in Salt Lake City and the Council Bluffs, Iowa Public Library. Peter Peterson lived just east of the Reel's Cemetery. Two of the Thomas children are interred in the Reel's Cemetery in unmarked graves, and two others married children of Peter Peterson. This is a carefully researched and well-written family history. I regret that it is not on-line for everyone to see.

## Reel's Cemetery - On-Line Biographies and Obituaries

Name	Source
Bybee, Alfred	1891 Lewis, p. 664 at <a href="http://homepages.rootsweb.ancestry.com/~gonfishn/bhopci/b/bybeea.html">http://homepages.rootsweb.ancestry.com/~gonfishn/bhopci/b/bybeea.html</a>
Dunkle, David	1891 Lewis, pp. 347-348 at <a href="http://iagenweb.org/pottawattamie/Bios1891-D.htm">http://iagenweb.org/pottawattamie/Bios1891-D.htm</a>
Dunkle, Reuben	1907 Field, pp. 1085-1087
Dutrow, Obadiah	1907 Field, pp. 1072-1075 at <a href="http://www.ebooksread.com/authors-eng/homer-howard-field/history-of-pottawattamie-county-iowa-from-the-earliest-historic-times-to-1907--lei/page-51-history-of-pottawattamie-county-iowa-from-the-earliest-historic-times-to-1907--lei.shtml">http://www.ebooksread.com/authors-eng/homer-howard-field/history-of-pottawattamie-county-iowa-from-the-earliest-historic-times-to-1907--lei/page-51-history-of-pottawattamie-county-iowa-from-the-earliest-historic-times-to-1907--lei.shtml</a>
Greene, John S.	obit: genealogytrails
Hansen, Niels	1907 Field, pp. 1192-1193
Heaston, Albert	obit: genealogytrails
Latham, Edmund	1891 Lewis, pp. 675-676
McKeown, William (first wife is buried in Reel's)	1891 Lewis, pp. 356-357 at <a href="http://iagenweb.org/pottawattamie/Bios1891-M.htm">http://iagenweb.org/pottawattamie/Bios1891-M.htm</a>
McMullen, Alfred H.	obit genealogytrails
McMullen, James Henry	obit genealogytrails
McMullen, Solomon H.	1883 Baskin (part 2, p. 116) 1907 Field, pp. 1082-1085, in genealogytrails; obit genealogytrails
Oamek, Christopher	obit genealogytrails
Reel, Perry	1883 Baskin (part 2, pp. 117-118)
Reel, William A.	obit genealogytrails
Reel, Clay D. (Perry Reel's son)	1891 Lewis, pp. 301-302 at <a href="http://homepages.rootsweb.ancestry.com/~gonfishn/bhopci/r/reelcd.html">http://homepages.rootsweb.ancestry.com/~gonfishn/bhopci/r/reelcd.html</a> ; obit genealogytrails
Rief, Claus	obit 15 Sep 1881 (burial place unknown)
Rief, Peter	1907 Field, pp. 396-398, at genealogytrails,
Rief, Sievert	1907 Field, pp. 1076-1078, at genealogytrails; obit genealogytrails
Rief, Minnie	obit genealogytrails



(Peter's dau.)	
Schroeder, Charlotte (Dorscher)	obit genealogytrails
Wager, Catherine Mary (Panning)	obit genealogytrails

- "1883 Baskin", "1891 Lewis" and "1907 Field" refer to Pottawattamie County biographical histories listed earlier in the Sources section
- "genealogytrails" refers to the website *genealogytrails.com/iowa/pottawattamie*
- obituaries with a date come from the Council Bluffs *Nonpareil*

### **The First Mormons - 1846 and 1847**

Forced to leave Nauvoo, Illinois and the surrounding area near the Mississippi River, three waves of Mormons travelled west across southern Iowa in 1846. Perhaps 10,000 individuals made this trek that first year. Most settled temporarily along the Missouri River in what was then known as the Council Bluffs area.



### **The Nauvoo Later Day Saints Temple**

destroyed by gentiles after the Mormon expulsion of 1846 - rebuilt in recent years  
Several Mormon camps were located near Reel's Cemetery. In particular, Bybee's Camp, established in 1847, spread out along North Pigeon Creek just to the east of what later became Reel's Cemetery.

In 1852 the majority of the remaining Mormons left the Council Bluffs area for Utah.

Among Reel's Cemetery burials are representatives of three families from Bybee's Camp, which extended for several miles along North Pigeon Creek. These individuals returned to the Bybee's Camp area, where they then lived out the remainder of their lives.

- **Bybee - Alfred Bybee** and his wife, **Mary Polly Walker**.

After traveling to Utah, Alfred Bybee became a member of the early Mormon colony in San Bernardino, California. This colony was temporarily disbanded during the Utah Mormon War in 1857-58. Alfred Bybee then backtrailed to Pottawattamie County in 1861, where his farm at the corner of Boomer, Rockford, Hazel Dell and Crescent Townships included portions of all four townships.

- **McKeown and Hall - Eliza Jane (Hall) McKeown**, William McKeown's first wife. You can see the farms of William McKeown and his son on the Section 31 plat on an earlier page.

Many Mormons died during the lifetime of the camps, including William McKeown's mother; most were interred in scattered locations and are lost to time. One interment, of a mother and infant, was once uncovered on the hillside east of Bybee's camp.

## **Settlers from Central Indiana - beginning in the early 1850s**

**Background:** Some of the Mormons who settled near the Missouri River in 1846 and 1847 came from the Putnam County area in central Indiana. These early Mormons included the McIntosh, Hall and Goodwin families of Putnam County.

In 1850, William A. Reel traveled from Putnam County to the Council Bluffs area and bought claims from some of the Mormon residents who were planning to move to Utah. In the spring of 1852, Reel came to the banks of Pigeon Creek where he took up milling, perhaps purchasing the former Bensons mill.

During the 1850s William A. Reel presence attracted a large number of family members and neighbors from Putnam and Clay Counties, Indiana. These families tended to settle in the loess hills area from Pigeon Creek northward into what became Harrison County.

Many of the central Indiana settlers in the Reel's Cemetery area belonged to the Primitive Baptist Church in Loveland. William A. and Sarah Reel were among the seven founders of this congregation in 1856.



### **The Loveland Primitive Baptist Church around 1880**

Still standing but used as storage in 2016

Courtesy of the Pottawattamie County IAGenWeb Project at

<http://iagenweb.org/pottawattamie/hist-CB-PBC.htm>

William A. Reel died suddenly in 1860 leaving only one son, Perry, living in the area. Perry Reel did not have a long life, dying at the age of 51. However, Perry served for many years as a Pottawattamie County official, including ten years as sheriff.

The following families from Putnam and Clay counties in central Indiana are represented among the Reel's Cemetery burials.

- **Boone:** Maxine Stansell added Robert Emmet Boone (1 Apr 1809 - 5 Dec 1857) to the Reel's Cemetery portion of findagrave.com in 2001. Robert Emmet Boone appears to be a grandnephew of Daniel Boone.

Robert Emmet Boone married Elizabeth Purcell in Putnam County in 1835. She was daughter of Jesse Purcell, an early settler in Harrison County. Robert Emmet's sister married into the McIntosh family, early settlers in Crescent Township.

Robert Emmet Boone is not in the 1984 Reel's Cemetery reading of stones. This is not surprising since he died in 1857 and perhaps never had a stone or his stone deteriorated or was lost. However, his findagrave.com entry gives a death place of Woodbine, Iowa and I wonder why his body would have been brought to Reel's Cemetery rather than being buried in the Purcell Cemetery, which is on land purchased by Jesse Purcell in 1856.

Thus I wonder if Robert Emmet Boone's inclusion in the list of Reel's Cemetery burials is in error.

- **Davis - Ezra Davis** his first wife, **Ellender Anderson**, and their daughter, **Martha (Davis) McCormick**, lived in Washington Twp., Putnam County before coming to Pottawattamie County in the 1850s. Ezra Davis was a blacksmith.
- **Jones - Sarah (Reel) Jones**, daughter of William A. Reel, was born in Putnam County and is interred with her children, **John P. Jones** and **William D. Jones**.
- **Knight - Houston Knight's** wife, **Elizabeth Reel**, was born in Putnam County to John Allen Reel.
- **Latham - Edmund Latham** was born in Clay County and married **Nancy Reel**, the daughter of William A. Reel.
- **McCoid - Nathaniel McCoid** and his wife, **Mary Sarchet**, lived in Washington Twp., Putnam County before coming to the Boomer Township area. **Donald D. McCoid** was a great-grandson.
- **Reel** - see the Reel section on the next page.

## The Reel Family

The Reel's Cemetery in Pottawattamie County, Iowa is located on land once owned by the Reel family. Here is a very brief summary of early Reel family history:

Henry Reel, a German immigrant, and Martha "Patty" Akers married in Franklin County in southeastern Virginia in 1790.

Around 1800 the Reel family moved to Montgomery County in southwestern Ohio. Here Henry and Martha Reel died.

In the early 1820s a number of Henry and Martha's children moved to central Indiana, locating in Washington Township in the southwest corner of Putnam County. Here some family members worked as millers.

In 1850 William A. Reel, a son of Henry and Martha Reel, traveled to Pottawattamie County, Iowa and purchased claims from Mormons planning to move on to Utah. In 1851 members of the extended Reel family began to move from Putnam County to Pottawattamie and Harrison Counties, Iowa.

For many years William A. Reel, his son and grandson, and members of the Paris and Wager families operated a mill along Pigeon Creek. During Mormon tenure in Pottawattamie County this had probably been the Benson gristmill, but there was also an associated sawmill established at some point.

There was a post office appropriately named Reels in the vicinity from 1884 to 1904. This replaced the earlier Harrison post office along North Pigeon Creek operated by the Peterson and Axtell families. (Around 1904 post offices in the Iowa countryside were closed because of the advent of rural free delivery.)

The Reel family had a gift of locating near transportation corridors both in Indiana and Iowa.

- In Indiana they lived near the National Road, an early federal public works project. built through Putnam County around 1832. In 1852 the Reel family established the village of Reelsville in Putnam County along an Indianapolis to Terre Haute railroad.
- In Iowa William A. Reel's former mill site ended up being alongside the 1920's Lincoln Highway, the nation's first transcontinental highway. His brother, Henry, located in central Harrison County to the north in 1854, and in 1867 the first railroad into Council Bluffs, the Northwestern, passed through Henry's land. Henry Reel assisted in laying out the 1867 town site of Logan, Iowa on Henry Reel property.

On the following page I have listed in boldface the early members of the Reel family known to have lived in northwestern Pottawattamie County and in adjoining Harrison County.



- William A. Reel's brother, Henry, lost three sons in the Civil War.

Henry Reel (1750 - 1827) & Martha "Patty" Akers (1763 - 1810)

John Allen Reel (1793 - 1858) & Sarah Beeson (1794 - 1859)

**Mary Magdalene Reel (1815 - 1865) & Champion Frazier (1813 - 1895)**

Daniel M. Reel (1825 - 1888) & Rachel Ann McElroy (~1830 - )

**Elizabeth Reel (1826 - 1856) & Houston Knight (~1818 - 1862)**

**John Allen Reel (1833 - 1909) & Amanda A. E. Jones (1837 - 1907)**

Lydia Reel (1799 - 1842) & Abraham Cox (1787 - 1849)

**Isaac Wiseman Cox (1817 - 1901) & Mary Ann Deal (1822 - 1910)**

**Jacob Cox\* (1820 - 1902) & Sarah Fox (~1823 - 1853)**

**Jacob Cox\* (1820 - 1902) & Hannah Isabel Frazier (1838 - 1932)**

**Andrew Reel Cox (1822 - 1898) & Barbara Jane Deal (1825 - 1914)**

**Henry Baker Cox (1826 - 1911) & Caroline Reel (1833 - 1887)**

**William Akers Reel (1798 - 1860) & Sarah Murphy (1801 - 1879)**

**Nancy Reel (1827 - 1860) & Edmund Latham (1824 - 1902)**

**Martha Reel (~1830 - ) & John Harrison Latham (~1835 - )**

**Mary Henrietta "Marietta" Reel (1836 - 1875) & Michael Goodwin (1829 - 1910)**

**William Riley Reel (1837 - 1898) & Eveline Mary "Eva" Lawrence (1837 - 1909)**

**Perry Reel (1838 - 1889) & Millie Branson (1845 - 1935)**

**Sarah Ella Reel\* (~1840 - 1925) & Jonathan Jones (1843 - 1916)**

**Sarah Ella Reel\* (~1840 - 1925) & unknown unknown**

**Elmira Reel (~1845 - )**

Andrew Reel (1799 - ) & Nancy Murphy (~1807 - )

**Caroline Reel (1833 - 1887) & Henry Baker Cox (1826 - 1911)**

**Henry B. Reel\* (1803 - 1890) & Catherine Starr (1806 - 1882)**

**Henry Blackburn Reel\* (1828 - 1863) & Rhoda E. Weatherly (~1828 - <1861)**

**Henry Blackburn Reel\* (1828 - 1863) & Sarah Ann Frazier (1838 - 1920)**

**Mary Jane "Martha" Reel (1832 - 1865) & Lowery B. Wilson (1833 - 1907)**

**Sarah Ann Reel (~1836 - 1866) & James Richardson**

**Oliver Perry Reel (1836 - 1865) & Mary D. Drake**

**John Henry Reel (1838 - 1864)**

**Lydia Reel (1841 - 1923) & William Brayton (1839 - 1911)**

**Catherine Reel (1845 - 1870) & Ethan Cole (1832 - >1920)**

**Henry B. Reel\* (1803 - 1890) & Nancy Wilson**

Despite being community leaders, the Reel family witnessed more than its share of sadness:

- In 1856 William A. Reel's niece, Elizabeth (Reel) Knight, died at age 29 and became the first known burial in the Reel's Cemetery.
- William A. Reel's daughter, Sarah, married Jonathan Jones. In 1878 Jonathan Jones shot and killed a Hazel Dell Township neighbor, David Roberts. Sarah spent most of her subsequent life in mental institutions. Jonathan Jones was tried and acquitted and probably died in Oklahoma.
- William A. Reel's brother, Henry, lost three sons in the Civil War.

### **Reel's Cemetery Burials - Reel Family** (boldface denotes Reel's Cemetery burials)

**William Akers Reel & Sarah Murphy**

**Nancy Reel & Edmund Latham**

**Perry Reel & Millie Branson**

**Dora E. Reel**

**Nancy Reel**

Clay D. Reel & Anna Walker

**Clay Dean Reel**

**Mary Reel**

**Sarah Ella Reel & Jonathan Jones**

**John P. Jones**

**William D. Jones**

John Allen Reel & Sarah Beeson

**Elizabeth Reel & Houston Knight**

## **The Later Mormons - beginning in the early 1850s**

I estimate that several thousand individuals who once belonged to the mainstream Mormon Church, known as the Latter Day Saints (LDS) either dropped out before crossing to Utah or backtrailed from Utah and settled in southwestern Iowa or nearby in eastern Nebraska.

Many former LDS members subsequently became members of the Reorganized Church of Latter Day Saints (RLDS), now the Community of Christ, which was established in 1860. The Community of Christ Church in Crescent is still active. At one time there was a North Pigeon branch of the RLDS Church, as well as RLDS branches further east in Boomer and Hazel Dell Townships.



**Crescent Reorganized Latter Day Saints Church**  
(still the home of the Crescent Community of Christ congregation)

The McMullen and Dunkle families, related by several marriages and well represented in Reel's Cemetery burials, moved from western Missouri to the Crescent area beginning in 1852 and later became RLDS members.

The following families represented in the Reel's Cemetery were members of the RLDS Church: Except for the Green and the Thomas family, most of these families married into the McMullen family.

- **Butler - Joseph Butler**, his wife **Mary Catherine McMullen**, and their children **Willie, Etta and Netta**. Mary Catherine was the daughter of Solomon McMullen.
- **Clark - Frank Bailey Clark**, the infant son of William Clark and Sarah Cusworth, who lived in Hazel Dell Township, Section 4. The Cusworth family had backtrailed from Utah and settled in southwestern Boomer Township in Section 32.
- **Dunkle - William Dunkle**, his son **David Dunkle**, and his daughter **Mary Ellen Dunkle**, the wife of Solomon McMullen.
- **Dutrow - Etta May Dutrow**, the granddaughter of Obadiah Dutrow and Martha McMullen. Martha McMullen was the sister of Solomon McMullen.
- **Green or Greene - John S. Green and Ida (Barton) Green**. John S. Green was born in England around 1849 and immigrated as a child around 1860. Ida Barton was born in Illinois to C. H. and Rebecca Barton. Her family came to Crescent Township via Washington County, Missouri in the 1860s. Her father died in 1869, whereupon the Barton farm was sold to Mr. Wilding,, a sale later disputed in a legal case that went all the way to the Iowa Supreme Court. John S. and Ida Green had two daughters and lived in the Reels area. He was buried by the RLDS pastor from Hazel Dell Township.
- **Heaston - Albert Heaston**, his wife, **Amanda Jane McMullen**, and their children **Nellie Heaston, Minnie Heaston, Ella Heaston and Esta Heaston**. Amanda Jane McMullen was the daughter of Solomon McMullen.
- **Lewis - Mary E. (Lewis) Jones**, the widow of John Jones. She was the daughter of William Lewis and Mary Evans, Welch Mormons who backtrailed and settled on what later became the William Price Jr./Frank Miner/Freddie Schroder farm in south central Boomer Township, Section 28.
- **McC Campbell - William McC Campbell** and children **Willis McC Campbell, Sarah McC Campbell and Nettie Grace McC Campbell**. William McC Campbell was the husband of Susan Elizabeth McMullen, the daughter of Alexander McMullen.
- **McMullen** - see the McMullen appendix for more information
- **Thomas - David Thomas and Hiram Thomas**, sons of Thomas Thomas and Martha Evans. The boys never had stone markers; their wooden markers were destroyed many years ago in a grass fire.

The Thomas Thomas family went to Utah from Wales in 1852 and backtrailed to the Boomer Township area with other relatives in 1866. Two of their sons married daughters of Peter Peterson of Boomer Township, Section 31.

**Related Information:** Living near Pigeon Creek to the east and northeast of the Reel's Cemetery site was another community containing a substantial number of former Mormons. Most members of this community were from England, Wales, or Canada.

Many of the Boomer Township "English" belonged to the Boomer branch of the RLDS, and many are buried in the Grange Cemetery, established in the 1870s, about two miles northeast of Reel's Cemetery.

## The McMullen Family

William McMullen, a number of his children, and the associated William Dunkle family were early settlers in the Crescent, Iowa area, arriving in the early 1850s.

William McMullen, his first wife, Ann Vendevar, and their first four children were born in Rockingham County, Virginia, near Harrisonburg.

In the early 1820s the William McMullen family moved to Montgomery County, in southwestern Ohio near Dayton. Soon thereafter Ann died and William married Catherine Myers.

By 1840 the William McMullen family was living in Jefferson Township, Montgomery County just west of Dayton.

In the 1840s William and Catherine and most of his children moved to Lawrence County in southwestern Missouri, where Mrs. McMullen died and the older children married.

Starting around 1852, William McMullen and the majority of his children traveled north, with William and a number of his children settling in the Crescent area of Pottawattamie County, Iowa.

The William McMullen family was closely related to the William Dunkle family, which also lived in Montgomery County, Ohio before moving to western Missouri, and then moved to the Crescent area around 1852. Both William McMullen and William Dunkle lived unusually long lives.

McMullen family members in the area tended to live near the town of Crescent, or a few miles to the east in west central Hazel Dell Township.

Both McMullen and Dunkle family members joined the Reorganized Latter Day Saints (RLDS) church in Crescent, although I don't know if they were members of the Mormon faith before moving to the Crescent area.

On the following page is a draft chart of William McMullen's children as taken from different Internet sources. **Some dates on this chart are inconsistent with other Internet sources.**



## Known Children of William McMullen and Ann Vendevar

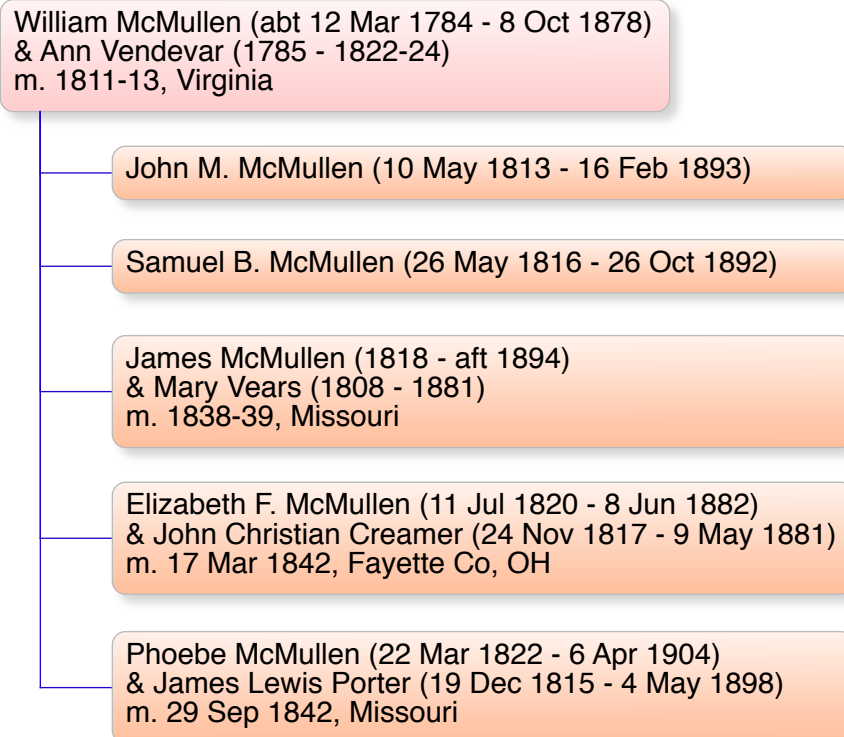

**John M. McMullen** married Martha Jordan and Elizabeth McDonald and had seven known children. He died in Wyoming, Stark County, Illinois.

**Samuel B. McMullen** married Elizabeth Janes and had ten known children. He died in Illinois, perhaps in McLean County.

**James McMullen** moved from Ohio to Missouri. The James McMullen family subsequently settled in Iowa, perhaps in Mills County.

**Elizabeth "Betsy" McMullen** and her husband, John Christian Creamer, moved from Ohio to Iowa, and eventually settled in Mills County. They had ten known children.

**Phoebe McMullen** married James Porter in Missouri. The James Porter family moved from Missouri to central Harrison County, Iowa around 1853. In 1866 they moved to the Lincoln, Nebraska area, where they remained. James and Phoebe Porter had six known children, one of whom died in the Civil War. James and Phoebe Porter and are interred in Yankee Hill Cemetery in Lincoln.

## Known Children of William McMullen and Catharine Myers

William McMullen (abt 12 Mar 1784 - 8 Oct 1878)  
& Catherine Myers ( - 10 Nov 1848)  
m. 5 Feb 1824, Fayette Co., OH

Alexander Reuben McMullen (abt 1824 - 17 May 1865)  
& Eliza A. Flesher (abt 1827 - )

David William McMullen (abt 1825 - bef 1865)

Henry Clay McMullen (13 Nov 1826 - 6 Sep 1901)  
& Margaret Elizabeth Snow (abt 1824 - )  
m. 8 Sep 1848, Lawrence Co., MO

Henry Clay McMullen (13 Nov 1826 - 6 Sep 1901)  
& Mary Jane Hankins (1821 - 11 Nov 1881)  
m. 8 Dec 1853, Lawrence Co., MO

Henry Clay McMullen (13 Nov 1826 - 6 Sep 1901)  
& Elizabeth Fonner (20 or 30 Jan 1831 - 12 Jun 1897)  
m. 23 Nov 1882, Pott. Co., IA

Mary Ann McMullen (abt 1830 - Apr or May 1865)  
& John H. Bone (1830 - Jun or Jul 1865)  
m. Jul or Aug 1860, Ohio

Elizabeth McMullen (aft 1830 - )  
& James McMillen (abt 1824 - bef 1883)  
m. 15 Aug 1867, Pott. Co., IA

Solomon Fletcher McMullen (6 Jun 1832 - 6 Dec 1914)  
& Mary Ellen "Ellen" Dunkle (10 Jan or 10 Mar 1835 - 10 Jul 1901)  
m. 2 Dec 1852, Crescent, Pott. Co., IA

Margaret McMullen (28 Jan 1834 or 1835 - 19 Jul 1883)  
& David Dunkle (4 or 14 Mar 1834 - 10 Jun 1905)  
m. 19 Dec 1852, Pott. Co., IA

Martha Emily McMullen (17 Jul 1836 - 29 Mar 1925)  
& Obadiah Henry Dutrow (2 Jan 1835 - 6 Nov 1918)  
m. 10 Dec 1857, Pott. Co., IA

## William McMullen's Children

- Solomon McMullen and Margaret McMullen married siblings, Ellen Dunkle and David Dunkle, the children of William Dunkle.
- William McMullen is interred in the Reel's Cemetery in southwestern Boomer Township, about five miles northeast of Crescent.

**Alexander McMullen** and his wife, Eliza, came to Pottawattamie County before 1853 but by 1856 were living in Jefferson County, Kansas, west of Kansas City. They had eight known children, two of whom returned to Pottawattamie County. Another two children ended their lives in Blackfoot, Idaho. Alexander is interred in Reel's Cemetery.

**David McMullen** was listed as head of household in the 1854 Iowa census for Rocky Ford Township, Pottawattamie County. (Rocky Ford Township included what later became Crescent Township). I know nothing about David McMullen's later life. I have seen no evidence that he married, and I am trusting an on-line source that he died no later than 1865.

**Henry Clay McMullen** and his second wife remained in Lawrence County, Missouri until moving to Pottawattamie County around 1855. He apparently remained in or near the town of Crescent, Iowa for the remainder of his life. Henry had three known children by his first wife, and two by his second. Henry and his second and third wives are interred in Reel's Cemetery.

**Elizabeth McMullen** married James McMillen, an Indiana native and early resident of Pottawattamie County who was a widower with two children, his previous wife being Hannah Poe. I have read that James McMillen died at a fairly young age; I have no idea what happened to Elizabeth.

**Solomon McMullen** was a prosperous farmer along Little Pigeon Creek (now Crescent Creek) in southwestern Hazel Dell Township, a few miles east of Crescent. (Hazel Dell Township was split off from Crescent Township around 1872.) He and his wife, Ellen, had six children. Their farm remained in the McMullen family for many years thereafter; there are some nice photos on the Internet. Solomon and Ellen McMullen are interred in Reel's Cemetery.

**Margaret McMullen** and her husband, David Dunkle, lived in or near the town of Crescent. After her death, David and some of their four children moved to Omaha, Nebraska. David and Margaret McMullen are interred in Reel's Cemetery.

**Martha McMullen** and her husband, Obadiah Dutrow, lived a mile or two northwest of the town of Crescent. They had four children. Obadiah and Martha Dutrow are interred in the Crescent Cemetery.

## **Reel's Cemetery Burials - McMullen Family**

(boldface denotes Reel's Cemetery burials)

**William McMullen** & Catherine Myers

**Alexander McMullen** & Eliza A. Flesher

Willis McMullen & Sarah Jane Cass

**Olive May McMullen**

Susan Elizabeth McMullen & **William McCampbell**

**Willis McCampbell**

**Sarah L. McCampbell**

**Nettie Grace McCampbell**

**Henry Clay McMullen** & Margaret Elizabeth Snow

**William M. McMullen** & **Carrie M. Jensen**

**Henry Clay McMullen** & **Mary Jane Hankins**

**Henry Clay McMullen** & **Elizabeth Fonner**

**Solomon Fletcher McMullen** & **Mary Ellen Dunkle**

**Mary Catherine McMullen** & **Joseph Henry Butler**

**Willie Butler**

**Etta Butler**

**Netta Butler**

**Amanda Jane McMullen** & **Albert Heaston**

**Nellie Heaston**

**Minnie Heaston**

**Ella Heaston**

**Esta Heaston**

**John William McMullen** & **Maybelle Brownell**

**Daisy McMullen**

**Burty McMullen**

**Lucy McMullen**

**Daniel Boone McMullen** & **Amelia Emma Rann**

**John Jay McMullen**

**Anna Laura McMullen**

**Margaret McMullen** & **David Dunkle**

## **The North Germans - beginning in the 1860s**

**Related Information:** A number of the early residents in or near Boomer Township had years of experience in the west, most often as teamsters, before settling in the Boomer Township area. The first North German known to have settled in the Boomer Township area was Chris Oamek, who earlier was a teamster freighting between the Missouri River and the Rockies. In 1866 Chris married a widow whose husband had been killed by Indians in Colorado in 1861 and raised a second family in western Hazel Dell Township.

Around 1864, young male members of the extended Rief family from Erfde, Schleswig, in far northern Germany immigrated, generally pausing in Chicago. Sievert Rief seems to have been the leader of the group of Schleswigers who settled north of Crescent.

The Schleswigers who followed the Rief family to the Boomer Township area were soon joined by a number of families from rural Hanover, just west of Hamburg, Germany.

In the 1890s these North Germany families built the church pictured below.



**St. John's Lutheran Church, Boomer Township**  
courtesy of Tom McLaughlin

The following North German families are represented in the Reel's Cemetery. I believe they are all from Schleswig except for the Oamek family. The majority have familial connections with the Rief family.

- **Erichson - Fred F. Erichson** and children **F. F. Erichson** and **Rosa Erichson**.  
Fred F. Erichson was the first husband of Rose Rief, the daughter of Peter & Sophia (Mandelko) Rief.
- **Juergens - Maria C. (Schroeder) Juergens**, the wife of Peter Juergens of Boomer Twp. Section 29.
- **Oamek - Johann Christofer "Chris" Oamek**, his second wife, **Mary (Straub) Sigea**, and a granddaughter, **Agnes Oamek**.
- **Rief** - see the Rief appendix for more information.
- **Ritchie - Robert Edward Ritchie** married Tillie Schroeder, the daughter of Claus & Charlotte Schroeder and died at an early age.
- **Schroeder - Claus & Charlotte (Dorscher) Schroeder** and children **Claudius**, **Willie** and **Anna** of Hazel Dell Section 6, just south of the Reel's Cemetery.
- **Vogt & Thode - Hans Hinrich Vogt and Frederika Mandelko** and their son, **Charles Vogt** of Crescent Township, Section 13; Hans' stepfather and mother, **Max Thode** and **Wiebke Thiessen**.  
The Vogt family had sixteen children. Hans Hinrich's sister, Christina, was married to Juergen Rief of Crescent Township. Frederika's sister, Sophia, was married to Peter Rief of Hazel Dell Township.
- **Witt - Jacob Peter "Peter" Witt** and his wife, **Margaretha Julia "Julia" Sievers**.  
Their son, **Detlef Witt**, and his wife, **Anna Margaretha Carstens**.  
Their daughter, **Caroline Margaretha "Lena" Witt**, Sievert Rief Sr.'s first wife.  
**Julia Witt**, **Detlef Witt**, and **Wilhelm Witt**, grandchildren by Detlef Witt.  
**Caroline Adelheid Witt**, granddaughter by Jacob Holm Witt and Margaret Reese.

**Related Information:** The Grange Cemetery two miles to the northeast also contains the graves of many immigrants from north Germany, especially from rural Hanover in Germany, just west of Hamburg. These immigrants, along with the Witt family from Schleswig, generally settled in central and northern Boomer Township and just to the north in southern LaGrange Township. Wohlers is the most-common surname among the Hanover immigrant group.



## **The Rief Family**

Sievert Rief Sr. along with five of his brothers and four male cousins came to the United States as single young men, mostly in the 1860s. His uncle Hans settled near Grand Island, Nebraska.

In the list on the following page, I have indicated in boldface the family members who lived in northwestern Pottawattamie County.

The Rief family all came from Erfde in Schleswig in north Germany. Several stopped in the Chicago area for a time before continuing west.

Sievert Rief (1759 - 1830) & Trien Margreth Paulsen (1776 - 1838)  
m. 9 Oct 1798, Erfde, Schleswig

Peter Rief (1803 - 1872) & Margaretha Ohm (1815 - 1867)  
m. 26 Aug 1838, Erfde, Schleswig  
**Peter Rief (~1845 - 1922) & Sophia Mandelko (1847 - 1926)**  
**m. 11 Nov 1882, Crescent, Pott. Co., IA**  
**Jacob Rief (1852 - )**

Sievert Rief (1809 - 1869) & Wiebke Schrum (1810 - 1873)  
m. 20 Oct 1839, Erfde, Schleswig  
**Sievert Rief Sr.\* (1840 - 1919) & Caroline Margaretha "Lena" Witt (~1844 - 1887)**  
**m. abt 1865, Chicago, Cook Co., IL?**  
**Sievert Rief Sr.\* (1840 - 1919) & Emma Rief (1864 - 1930)**  
**m. 1888, Grand Island, Hall Co., NE**  
**Juergen "John" Rief\* (1842 - 1924) & Christina Vogt (1841 - 1885)**  
**m. 1865, Chicago, Cook Co., IL**  
**Juergen "John" Rief\* (1842 - 1924) & Antonette Edger (1860 - 1924)**  
**m. 22 Jan 1888, Pott. Co., IA**  
**Peter Rief (1845 - 1925) & Anna C. Thiesen (1848 - 1914)**  
**m. 12 May 1868, Pott. Co., IA**  
Wiebke Rief (1848 - )  
**Johann Rief (1850 - 1872)**  
**Hans Rief (1854 - 1922) & Catrina "Catherine" Seibeos (1854 - 1932)**  
**m. abt 22 Oct 1872, Pott. Co., IA**  
**Claus Rief (1856 - ~1881)**  
Margaretha Rief (1858 - )

Hans Rief (1814 - 1891) & Margarethe Brammer (1821 - 1909)  
m. abt 1840  
Charles Rief (~1842 - 1912) & Anna Catherina Sieck (1848 - 1922)  
m. abt 6 Dec 1871, Grand Island, Hall Co., NE  
Henry Rief\* (1846 - 1921) & Elizabeth Prahm (1852 - 1877)  
m. Nov 1869, Grand Island, Hall Co., NE  
Henry Rief\* (1846 - 1921) & Emma Christina Fischer (1859 - 1945)  
Anna Doratheia Rief (1850 - 1885) & Henry Hans Bockmann (1840 - 1912)  
m. abt 1877  
Margaretta Cathrina Rief (1855 - 1883) & Fredrick Langman (1850 - 1924)  
m. 6 Jun 1874, Grand Island, Hall Co., NE  
Mary Christina Rief (1859 - 1940) & Peter Clausen (1849 - 1918)  
m. 19 Oct 1878, Hall Co., NE  
Jurgen "George" Rief (1861 - 1947) & Anna Bucholtz (1868 - 1949)  
m. 22 Feb 1890, Grand Island, Hall Co., NE  
**Emma Rief (1864 - 1930) & Sievert Rief Sr. (1840 - 1919)**  
**m. 1888, Grand Island, Hall Co., NE**  
William Rief (1866 - 1907) & Catherine Bielfeldt (1862 - 1949)  
m. 17 Feb 1892, Clinton, Clinton Co., IA

## Immigrant Sons of Sievert Rief and Wiebke Schrum

**Sievert Rief Sr.** emigrated about 1864 and came to Pottawattamie County several years later. There he settled in the Reels neighborhood near the boundary between Boomer, Rockford, Crescent and Hazel Dell Townships.

Sievert Rief Sr. was entrepreneurial. In addition to farming, he ran a rural grocery store. In the mid 1880s he built Rief's Hall, which stood in Hazel Dell Township Section 6 near Pigeon Creek on the road from Crescent to Honey Creek. Among other uses, Rief's Hall was used for dances and political meetings. I understand that Rief's Hall was destroyed in a windstorm in 1925.

In the 1870 census Sievert Rief was enumerated twice. On June 21 he was enumerated with his wife and oldest children in Crescent Township (Hazel Dell Township wasn't formed from Crescent Township until 1872.) On June 20 he had been enumerated with several of his younger children in Grand Island, Nebraska. Possibly he was homesteading land in Grand Island.

Sievert Rief Sr. was married twice with children (nine and five respectively) from each marriage:

- Sievert's first wife, Lena (Witt) Rief, was the sister of the Witt brothers who were early settlers in Boomer Township.
- Sievert's second wife, Emma (Rief) Rief, was the daughter of Sievert's uncle, Hans Rief, of the Grand Island area in Nebraska. Hans and his wife, Margarethe Brammer, immigrated in 1869.

Sievert Rief's first wife is interred in the Reel's Cemetery in Boomer Township. Sievert and his second wife are interred in Walnut Hill Cemetery in Council Bluffs.

**Juergen Rief** immigrated in 1864 and was a farmer living in Crescent Township, Section 13.

Juergen Rief was married twice with children (nine and four respectively) from both marriages.

- Juergen's first wife was a sister of Hans H. Vogt, who lived nearby in Section 13. They were children of Hinrich Vogt and Wiebke Thiessen.
- I know nothing about Juergen's second wife, Antonette Edger.

Juergen Rief moved to Council Bluffs between 1910 and 1915.

Juergen Rief's first wife is interred in the Reel's Cemetery in Boomer Township. Juergen and his second wife are interred in Walnut Hill Cemetery in Council Bluffs.

**Peter Rief** (brother) immigrated in 1864 through Quebec and came to Pottawattamie County in 1866. Peter originally farmed in the Boomer and Hazel Dell Township area.

By 1880 the Peter Rief family had moved to Council Bluffs where he was in the shoe business and then the sewing machine business for a time. By 1889 he was living in the Manawa area south of Council Bluffs, where he farmed, was briefly postmaster, and at one point ran a saloon.

Peter Rief moved back from Manawa to Council Bluffs before 1910. I can't find him in the 1920 census. Peter Rief died in Los Angeles County, California in 1925.

Peter Rief had five children.

Peter Rief and his wife are interred in Walnut Hill Cemetery in Council Bluffs.

**Johann Rief** may have farmed in Boomer Township before his early death. He is interred in Reel's Cemetery in Boomer Township.

**Hans Rief** was a farmer in Norwalk Township, living in Section 9 about a mile north of the town of Underwood. Not long after 1900 the Hans and Catherine Rief family moved to Alhambra about five miles northeast of downtown Los Angeles. While in Alhambra, Hans Rief was in the banking business.

Although Hans and Catherine Rief had five children, only one survived to adulthood. Their son, Julius Rief, married and had one child before his early death at 26.

**Claus Rief** is said to have died at Crescent in 1881 but I can't find him in the Pottawattamie County census. His obituary is in the *Council Bluffs Nonpareil*.

### **Immigrant Sons of Peter Rief and Margaretha Ohm**

**Peter Rief** (cousin) immigrated around 1864, came to the Crescent area shortly thereafter, and farmed in Hazel Dell Township.

In 1882 Peter married the widow Sophia (Mandelko) Bracker. Sophia was the sister of Mrs. Hans H. Vogt of Crescent Township, who is mentioned above. Sophia had two sons from a previous marriage to Johann Bracker.

By 1902 the Peter Rief family was living in the southeast corner of Hazel Dell Township, Section 7, in what was previously the Jonathan Jones farmstead. The Peter Rief farm remained in the family for many years thereafter.

Peter and Sophia Rief are interred in Reel's Cemetery in Boomer Township.

**Jacob Rief** farmed in Hazel Dell Township. His small farm appears in Section 18 on the north side of Simon's Run in the 1885 and 1902 township plats. He probably never married, and I know little about his life.

### **The Hans Rief and Margarethe Brammer Family**

Hans Rief was the uncle of Sievert Rief Sr. Hans Rief and Margaretha Brammer and their younger children immigrated from Erfde to the Grand Island area in Hall County central Nebraska in 1869.

#### **Here I mention several of their children.**

- Charles Rief was a seafarer who came to Grand Island around 1871. While living in Hall County, he served in the Nebraska Legislature. By 1900 the Charles Rief family left Hall County for Alameda County, California. Charles Rief's brother-in-law, Peter Schroeder, was an early resident of Boomer Township before moving to Nebraska.
- Henry Rief had immigrated in 1864 with his cousin, Peter Rief. He settled on a farm in Hall County in 1867.
- Emma Rief married her cousin, Sievert Rief Sr., and lived in Pottawattamie County, Iowa for the remainder of her life.

### **Reel's Cemetery - Rief Family Burials**

(boldface denotes Reel's Cemetery burials)

Peter Rief & Margaretha Ohm

**Peter Rief & Sophia Mandelko**

Rose Rief & **Fred F. Erichson**

**F. F. Erichson**

**Rosa Erichson**

Sievert Rief & Wiebke Schrum

Sievert Rief Sr. & **Caroline Margaretha "Lena" Witt**

Sievert Rief Jr. & Minnie Katherine Page

**J. Rief**

Juergen Rief & **Christina Vogt**

**Phoebe Christina Rief**

Henry Rief & Amanda Butler

**Emma Rosa Rief**

**Phoebe C. Rief**

**August Rief**

**Rosa M. Rief**

**Emma C. F. Rief**

**Johann Rief**

Hans Rief & Catrina "Catherine" Seibeos

**Gustuf S. Rief**

**Rudolph Rief**

**Tillie Rief**

## The Danes - beginning in 1867

Before 1867 I know of only one Danish immigrant living in the area, namely Peter Peterson, whose farm is shown on the earlier Boomer Township Section 31 plat. Peterson was a former California miner who settled in Section 31 in 1862 and then married his housekeeper, a Civil War widow named Rachel (Cady) Shadden.

Peter Peterson was from the Stevns Peninsula south of Copenhagen. After the Civil War ended in 1865, Peterson's presence attracted a number of other Stevens peninsula residents, including Christian Bondo, who later settled in northeastern Hazel Dell Township, and my great-grandparents, Christian and Anna Christiansen, who settled in central Boomer Township.

Danish Mormon dropouts in the Council Bluffs area sometimes attracted acquaintances or relatives from their old neighborhood in Denmark. For instance, Christian Peterson from Dronninglund northeast of Aalborg immigrated to northeastern Kansas with a Mormon company in 1855, but after three family members died he did not continue to Utah. In 1867 Christian Peterson settled in central Boomer Township. Subsequently around eight additional families from Dronninglund settled in Boomer Township. The Sources section that follows gives a link to my report about these Dronninglunders.

Three Danish immigrant families are represented in Reel's Cemetery:

- **Acton - Gregers Marcus Poulsen Acton** and wife, **Dorthe Marie "Mary" Nielsen**. The Gregers Acton family immigrated in 1867. Other family members are buried in the Grange Cemetery.

Gregers Acton and Christian Peterson, who was mentioned earlier, were both from Dronninglund in northern Jutland and bought Boomer Township farms on the same day in 1867. The Acton farm later became the Julius Schroder/Dale Schroder farm, although the Acton farmstead was near North Pigeon Creek.

- **Hansen - Niels Hansen's wife Ottoline (Aagaard) Hansen**, infant children **Laura Hansen** and **Lydia Hansen**, and single adult sons **Fremont Hansen** and **Bryan Hansen**.

Niels Hansen immigrated in 1880 from Snarup, which is between Odense and Svendborg on the island of Fyn. Niels Hansen's first farm was in Hazel Dell Township Section 6 just south of the Reel's Cemetery. Around 1902 he moved to a farm in Rockford Township near Loveland.

- **Marcussen - Jørgen Marcussen** and **Karen Jensen's children Jens Peder Marcussen, Marie Josofine Marcussen, and Rosefine Emma Marcussen**. The parents and three adult children are buried in the Mt. Hope Cemetery in West Point, Nebraska using the spelling "Marcuson".

Jørgen Marcussen and Karen Jensen and their family emigrated in 1869 from the Stevns Peninsula south of Copenhagen. They lived somewhere in northwestern Hazel Dell Township before moving to Nebraska in the early 1880s.

## Other Reel's Cemetery Burials

- **Benson - Nels Benson Sr.** and his daughter, **Ellen Benson**.

Nels Benson Sr. emigrated from Sweden with three children about 1870 and his wife and two remaining children several years later. He and his descendants lived in various locations in northwestern Pottawattamie County, including several locations near Reel's Cemetery. Nels' wife died during a visit to Crawford County, Iowa and is buried there.

Niels Benson's great-granddaughter, Bernice Benson, was my first grade teacher.

- **Lavenbarg - infant Lavenbarg** and **Paul H. Lavenbarg**, sons of Augustus Lavenbarg and Maggie Grant, Ohio natives of Ohio.

Augustus Lavenbarg had lived in the west earlier in his life. In the 1880 census he was listed as a trader (perhaps in horses) living near the Reel's Cemetery. In 1885 he was postmaster, farmer, stock raiser and dealer in general merchandise at Armour in southeastern Hardin Township.

- **Wager - Gustave Wager** and three of his children, **Rosa Wager**, **Oscar Wager** and **Emma Wager**.

In the 1850s the Paris and Wager families settled in the southern part of Hazel Dell Township, Section 6, where they participated in the operation of Reel's mill on Pigeon Creek.

Oscar Wager died leaving a widow, Emma French, and one child, Leona. Oscar's widow then married Oscar's brother, Louis Wager. Louis and Emma Wager had no children, leaving Leona Wager with the title to a nice farm at the very south end of Boomer Township.

## Notes - Reel's Cemetery Burials in My *St.Paul's* Database

- **Acton:** The 1984 Reel's Cemetery reading used the surname of "Gregers" for Gregers Marcus Poulsen Acton (20 May 1824 - 23 Feb 1969). Consequently findagrave.com has two entries for Mr. Acton.
- **Boone:** See the *Other Reel's Cemetery Burials* section.
- **Dunkle** I believe the two findagrave.com entries for William Dunkle refer to the same person. The section *Reel's Cemetery Burials From the St.Paul's Database* shows the dates I am using for William Dunkle.
- **Juergens:** Maria C. Schroeder married Peter Juergens who lived just to the west of the Grange Cemetery. Maria died in 1889 shortly after giving birth to her fourth child. Peter Juergens never remarried, and Maria's mother was living in the Juergens household in 1900 and 1905. Maria was buried in the Reel's Cemetery but is listed on the Juergens stone in the Grange Cemetery. I don't know if Maria's body was moved from the Reel's Cemetery to the Grange Cemetery.
- **Latham:** The stone that reads "Edmund Latham born Sept 17 1827, died Feb. 13, 1860" is missing its top. This is evidently the original stone for Nancy (Reel) Latham (1827 - 1860), the wife of Edmund Latham.
- **McMullen and Dunkle:** These two families were closely connected, coming to Pottawattamie County in 1852 from Lawrence County in southwestern Missouri and Andrew County in northwestern Missouri. See *The McMullen Family* for more information.
- **Reel:** See *The Reel Family* for more information.
- **Reel:** Clay Dean Reel (8 Jun 1898 - 28 Apr 1919) was initially buried in Reel's Cemetery. However, he has a stone in the Hardin Township Cemetery. His body may have been moved after his parents moved to Hardin Township.
- **Rief:** All the Reel's Cemetery burials with the surname Rief are related. See *The Rief Family* for more information.
- **Rief:** George Peter Rief. Findagrave gives death date 9 Aug 1870 and age 2y 1m 9d. 1984 cemetery book gives additional information: "son of S. and G. (sic, presumably C )" and places George Peter next to Sievert's first wife, Caroline. These imply a birthdate around 30 Jun 1868. However, this is unlikely considering the birthdate I have for Julia Margaret Rief. Here are my birthdates for Sievert and Caroline's three oldest children:
  - Wiebke Christine b. 21 Feb 1867.
  - Julia Margaret b. 8 Feb 1869
  - Sievert Jr. b. 5 Aug 1870.I am adding "?" to birth and death dates for George Peter Rief.



### Notes - Reel's Cemetery Burials Not in My *St.Paul's* Database

Name	1984 Report	FindAGrave	Notes
Barton, Ida	no	no	1858 - 15 Oct 1902; wife of John S. Green
Green, John S.	no	no	m. Ida Barton 1877; d. May 1923; obit 9 May 1923
Holland, wife of J. H.	yes	yes	d. 20 May 1868
Jack, Goldie June	yes	yes	d/o R. P. & A. G., d. 30 Jun 1894, 1y 11m 4d; obit 1 Jul 1894
Seaton, Charles	yes	yes	d. 6 Jun 1886, 17y 5m; Des Moines Register in newspapers.com 10 Jun 1886
Vomacka, Louise	no	yes	1884 - 1939; has a different stone in the Bohemian Cemetery in Omaha. I wonder if this is a mistake.

- Obituaries are in the Council Bluffs *Nonpareil*, per the index at <http://www.rootsweb.ancestry.com/~iapcgs/>

## Notes - The Wives of Reel's Cemetery - Maiden and Married Names

The following section lists the Reel's Cemetery burials that are in my *St. Paul's* database. For the married women in this list, the St. Paul's database gives their maiden names while the published and on-line Reel's Cemetery records generally give only the married name. Thus the following table, which gives both maiden and married names.

Maiden Name	First & Middle Names	Spouse's Name - last, first	
Aagaard	Ottoline M. "Lena"	Hansen	Niels
Anderson	Ellender	Davis	Ezra
Beeson	Sarah	Reel	John Allen
Branson	Millie	Reel	Perry
Brownell	Maybelle	McMullen	John Wiliam
Carstens	Anna Margaretha	Witt	Detlef "David"
Davis	Martha M.	McCormick	James R.
Dorscher	Charlotte Louise	Schroeder	Claus
Fonner	Elizabeth	Nusum McMullen	Jesse Frost Henry Clay
Fowler	Susana	Farris Forsyth	James S. John
Dunkle	Mary Ellen "Ellen"	McMullen	Solomon
Goss	Mary A. E.	Knight	Houston
Hall	Eliza Jane	McKeown	William
Hankins	Mary Jane	McMullen	Henry Clay
Jensen	Carrie M.	McMullen	William M.
Lewis	Mary E.	Jones	John
Mandelko	Sophia	Bracker Rief	Johann Bernhardt Peter
Mandelko	Frederika	Vogt	Hans Hinrich
Markham	Sarah	Harcot Pochin Billington	Samuel David Joseph
Murphy	Sarah	Reel	William A.
Nielsen	Dorthe Marie "Mary"	Acton	Gregers Marcus Poulsen
Panning	Mary Catherine "Catherine"	Wager	Gustave Celestine
McMullen	Margaret	Dunkle	David
McMullen	Mary Catherine	Butler	Joseph Henry

McMullen	Amanda Jane	Heaston	Albert
Reel	Elizabeth	Knight	Houston
Reel	Dora E.	Wager	Ernest
Reel	Nancy	Latham	Edmund
Reel	Sarah Ella	Jones	Jonathan
Sarchet	Marie "Mary"	McCoid	Nathaniel
Schroeder	Maria C.	Juergens	Peter
Sievers	Margaretha Julia "Julia"	Witt	Jacob Peter "Peter"
Straub	Mary	Sigea Oamek	Charles Johan Christofer
Thiessen	Wiebke	Peters Vogt Thode	Claus Hinrich Max
Vogt	Christina	Rief	Juergen "John"
Walker	Mary "Polly"	Bybee	Alfred
Witt	Caroline Margaretha "Lena"	Rief	Sievert

## Reel's Cemetery Burials Found in the St.Paul's Database

Results - 10 Jul 2016

Last Name	First & Mid Name	Birth Date	Death Date
Aagaard	Ottoline M. "Lena"	29 Oct 1855	13 May 1911
Acton	Gregers Marcus Poulsen	20 May 1824	23 Feb 1869
Anderson	Ellender	abt 2 Jul 1831	8 Feb 1873
Benson	Ellen	2 May 1862	3 Sep 1876
Benson	Niels	24 Feb 1821 or 17 Feb 1822	8 Aug 1899
Boone	Robert Emmet	1 Apr 1809	5 Dec 1857
Branson	Millie	May 1845	abt 15 Mar 1935
Brownell	Maybelle	9 May 1860 or 18 May 1861	28 Aug 1887
Butler	Etta	20 Feb 1897	19 Jul 1897
Butler	Joseph Henry	26 Mar 1845	26 Dec 1909
Butler	Netta	20 Feb 1897	19 Jul 1897
Butler	Willie	7 Feb 1889	4 Mar 1889
Bybee	Alfred	4 Nov 1810	19 Jun 1891
Carstens	Anna Margaretha	20 Dec 1844	30 Oct 1919
Clark	Frank Bailey	10 Jan 1870	10 Jan 1870
Davis	Ezra	abt 1821	abt 19 Mar 1882
Davis	Martha M.	abt 19 May 1849	30 Oct 1866
Dorscher	Charlotte Louise	May 1853	26 Feb 1909
Dunkle	David	4 or 14 Mar 1834	10 Jun 1905
Dunkle	Mary Ellen "Ellen"	10 Jan or 10 Mar 1835	10 Jul 1901
Dunkle	William	10 Jan 1781	29 Dec 1873
Dutrow	Etta May	Jan 1888	13 Apr 1888
Erichson	F. F.	20 Jul 1911	20 Jul 1911
Erichson	Fred F.	14 Jun 1886	9 Apr 1918
Erichson	Rosa	20 Jul 1911	20 Jul 1911
Fonner	Elizabeth	20 or 30 Jan 1831	12 Jun 1897
Fowler	Susana	abt 1827	20 Aug 1898
Goss	Mary A. E.	abt 1832	1 Mar 1861
Hall	Eliza Jane	10 Jul 1826	4 Feb 1870
Hankins	Mary Jane	1821	11 Nov 1881
Hansen	Bryan	16 Feb 1897	24 Oct 1928
Hansen	Fremont Royal "Monte"	30 May 1900	19 Jun 1936
Hansen	Laura	2 Aug 1891	5 Mar 1894
Hansen	Lydia	16 Feb 1897	6 Sep 1897
Harcot	Mary	14 Jul 1822	20 Feb 1873
Heaston	Albert	7 Oct 1850	26 Jul 1935
Heaston	Ella	22 Jul 1890	19 Mar 1891

Heaston	Esta	22 Jul 1890	19 Mar 1891
Heaston	Minnie	9 Aug 1882	14 Mar 1885
Heaston	Nellie	31 Jul 1881	17 Aug 1881
Jensen	Carrie M.	20 Aug 1854	11 May 1880
Jones	John P.	abt 3 Mar 1865	9 Jul 1873
Jones	William D.	15 Oct 1866	10 Sep 1867
Knight	Houston	abt 1818	6 Oct 1862 or 1863
Latham	Edmund	14 Jul 1824	13 Nov 1902
Lavenbarg	infant	25 Apr 1883	18 May 1883
Lavenbarg	Paul H.	19 Jun 1881	30 May 1882
Lewis	Mary E.	abt 21 Feb 1850	12 Mar 1872
Mandelko	Frederika	21 May 1856	16 Sep 1938
Mandelko	Sophia	14 Dec 1847 or 1848	23 May 1926
Marcussen	Jens Peder	11 Feb 1867	7 Apr 1872
Marcussen	Marie Josofine	13 May 1871	29 Jul 1872
Marcussen	Rosefine Emma	18 May 1877	bef 1880
Markham	Sarah	28 Jan 1804	19 Mar 1870
McC Campbell	Nettie Grace	15 Feb 1882	14 Oct 1885
McC Campbell	Sarah L.	16 Dec 1871	21 Jan 1872
McC Campbell	William	abt 31 Jan 1840	21 Jan 1891
McC Campbell	Willis	21 Jan 1870	22 Mar 1872
McCoid	Donald D.	14 Sep 1893	21 Nov 1893
McCoid	Nathaniel	12 or 13 May 1793	21 Oct 1870
McMullen	Alexander Reuben	abt 1824	17 May 1865
McMullen	Amanda Jane	30 Dec 1855	8 May 1895
McMullen	Anna Laura	18 Sep 1867	26 Mar 1887
McMullen	Burty		
McMullen	Daisy	1882	bef 1885
McMullen	Daniel Boone	3 Jun 1863	27 Jan 1891
McMullen	Henry Clay	13 Nov 1826	6 Sep 1901
McMullen	John Jay	17 Aug 1882	Oct 1882
McMullen	John William	16 Oct 1859	15 Sep 1887
McMullen	Lucy Ellen	1884	1885
McMullen	Margaret	28 Jan 1834 or 1835	19 Jul 1883
McMullen	Mary Catherine	30 Sep 1853	8 Apr 1931
McMullen	Olive May	6 Dec 1869	18 Sep 1878
McMullen	Solomon Fletcher	6 Jun 1832	6 Dec 1914
McMullen	William	abt 12 Mar 1784	8 Oct 1878
McMullen	William M.	4 Apr 1849	2 Jan 1883
Murphy	Sarah	2 Feb 1801	20 Dec 1879
Nielsen	Dorthe Marie "Mary"	12 Sep 1828	15 Jan 1905

Oamek	Agnes	16 May 1892	11 Aug 1892
Oamek	infant	1874	18 Feb 1874
Oamek (n. Omeg)	Johann Christofer "Chris"	abt Aug 1814	8 Mar 1901
Panning	Mary Catherine "Catherine"	16 Feb 1841	11 Apr 1917
Reel	Clay Dean	6 Jun 1898	28 Apr 1919
Reel	Dora E.	abt 24 Jun 1866	26 Apr 1888
Reel	Elizabeth	30 Jun 1826	23 Apr 1856
Reel	Mary		9 Sep 1873
Reel	Nancy		31 Dec 1882
Reel	Nancy	12 Sep 1827	13 Feb 1860
Reel	Perry	12 Jul 1838	10 Dec 1889
Reel	Sarah Ella	abt 1840	24 Aug 1925
Reel	William Akers	4 Jan 1798	9 Mar 1860
Rief	August	1878	1885
Rief	Emma C. F.	1882	14 Feb 1885
Rief	Emma Rosa	17 Jun 1901	16 Jun 1902
Rief	George Peter	? 30 Jun 1868	? 9 Aug 1870
Rief	Gustuf S.	abt Oct 1873	28 Feb 1879
Rief	J.	13 Feb 1893	24 Feb 1893
Rief	Johann	9 Nov 1850	18 Mar 1872
Rief	Peter	abt 9 Jan 1845	26 Oct 1922
Rief	Phoebe C.	1870	1875
Rief	Phoebe Christina	1867	1870
Rief	Rosa M.	1880	15 Feb 1885
Rief	Rudolph	abt Sep 1881	6 May 1882
Rief	Tillie	1883	15 Aug 1887
Ritchie	Robert Edward	13 May 1879	10 Jul 1913
Sarchet	Marie "Mary"	8 Aug 1802	18 Feb 1882
Schroeder	Anna A.	22 Feb 1891	13 or 18 Aug 1891
Schroeder	Claudius	25 Jun 1881	20 May 1882
Schroeder	Claus	13 Apr 1844	9 Jun 1896
Schroeder	Maria C.	20 Sep 1857	4 May 1889
Schroeder	Willie	29 Sep 1883	27 Feb 1885
Sievers	Margaretha Julia "Julia"	19 Nov 1819	25 Mar 1894
Straub	Mary	1839	1 Jan 1876
Thiessen	Wiebke	3 Jun 1806	1879
Thode	Max	26 May 1800	1883
Thomas	David	1855	1868
Thomas	Hyrum	1862	1869
Vogt	Charles	16 Jun 1883	2 Sep 1892
Vogt	Christina	1841	26 Sep 1885

Vogt	Hans Hinrich	7 Feb 1843	19 Dec 1901
Wager	Emma Annetta	16 Apr 1877	6 Sep 1878
Wager	Gustave Celestine	10 May 1826	5 Apr 1909
Wager	Oscar Alfred	21 Dec 1870	16 Aug 1897
Wager	Rosa Cecilia	27 May 1866	15 Oct 1867
Walker	Mary "Polly"	27 Oct 1809	25 Jan 1875
Witt	Caroline Adelheid	10 or 16 Sep 1886	18 Nov 1890
Witt	Caroline Margaretha "Lena"	abt 3 Jun 1844	6 Dec 1887
Witt	Detlef	abt Jun 1882	5 Dec 1882
Witt	Detlef "David"	14 Sep 1843	6 Dec 1899
Witt	Jacob Peter "Peter"	6 Feb 1815	9 Mar 1883
Witt	Julia	31 May 1869	14 Mar 1870
Witt	Wilhelm M.	6 Feb 1884	21 Mar 1888

**Total: 132**